

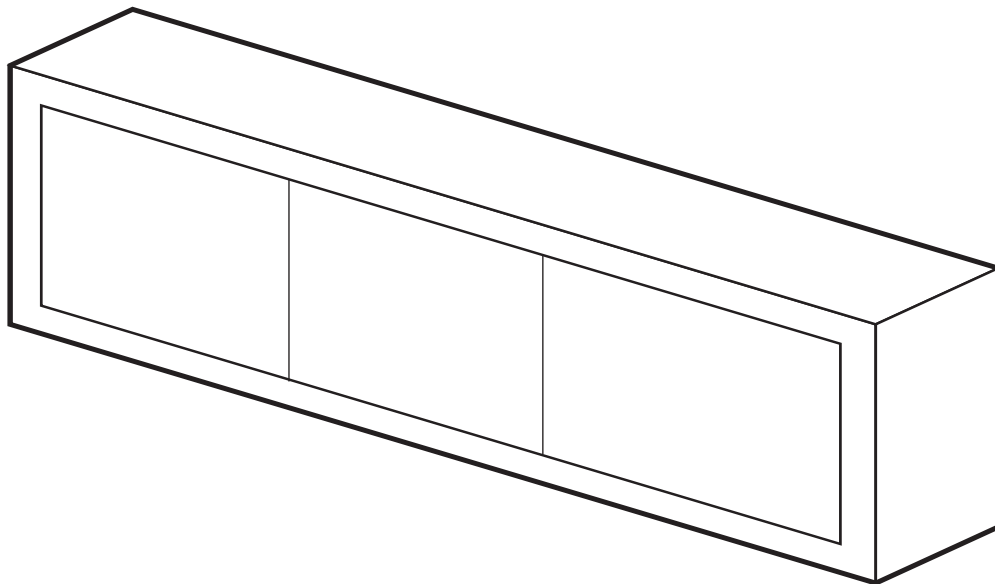

HOTASS SAUNAS

**Himalayan Salt Light Box
Installation and Operation Manual**



CONSIDERATIONS

- Power supply should be installed in a dry accessible location.
- Light Box and power supply should be tested prior to installation

INCLUDED

- Himalayan Salt Light Box
- Power Supply
- Power Cable
- Mounting Bracket and screws

SPECIFICATIONS

Himalayan Salt Light Box

Dimensions: 5-1/2"H x 25-1/2"W x 2-1/4"D

Composition: Plywood, Cedar, Himalayan Salt

Weight: 11lbs

Power Supply

Operating Voltage: 120V

Output Voltage: 24VDC

Power Consumption: 18W

Nominal Amperage: .45 A / 120V

Dimensions: 2.97"L x 1.25"W x 1.87"D

White LED Light

Type: LED White Light

Operating Voltage: 24VDC

Power Consumption: 8.64 Watts per panel

Lumens: 933

INSTALLATION DIAGRAM

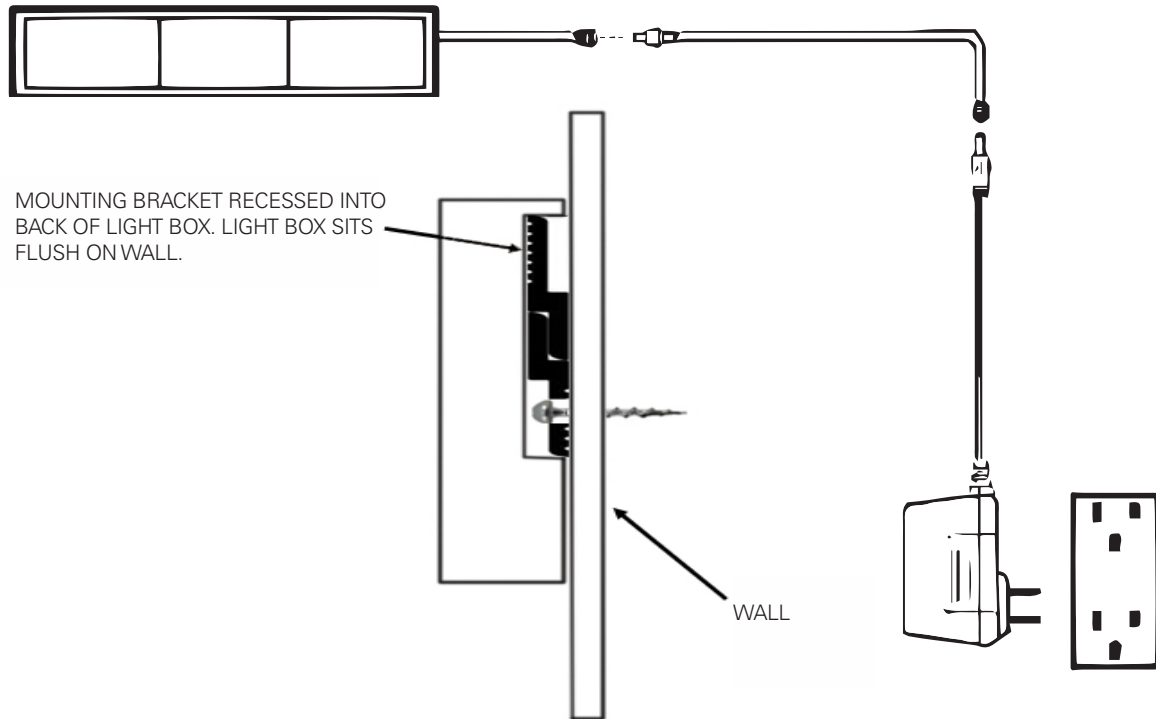

INSTALLATION

1. Determine the desired locations for the following: Light Box, and Power Supply.

Important: Power supply must be in an accessible, dry location. Note provided cord lengths are 50' maximum.

2. Install electrical boxes for the following: Light Box, and Power supply.
3. Run a 120VAC externally switched GFCI outlet to power electrical box supplying power to Power Supply.

Note: Electrical outlet for power supply can be switched if installing switch near room.

4. Route light extension cable from Power Supply to Salt Panel location.
5. Mount provided bracket on wall at determined location for Light Box.
6. Connect Light extension cable to Light Box then hang Light Box onto wall.
7. Plug power supply into GFCI outlet and verify light operation.