



# Himalayan Salt Feature White LED



Small Salt Feature / Large Salt Feature / Salt Wall

## Installation and Operation Manual

# Contents







<a href="#"><u>Safety &amp; Warnings</u></a>	-----	3
<a href="#"><u>Required Tools / Material</u></a>	-----	4
<a href="#"><u>Specifications</u></a>	-----	5
<a href="#"><u>Installation</u></a>	-----	6 - 11
<a href="#"><u>Custom Length</u></a>	-----	11
<a href="#"><u>Control operation</u></a>	-----	12
<a href="#"><u>Connection Diagrams</u></a>	-----	13 - 17
<a href="#"><u>Replacement Parts</u></a>	-----	
<a href="#"><u>Framing Dimensions</u></a>	-----	18 - 21
<a href="#"><u>Troubleshooting</u></a>	-----	22

## SAFETY & WARNINGS



### PLEASE READ THIS MANUAL IN ITS ENTIRETY PRIOR TO INSTALLATION!

-  **IMPORTANT** **Qualified Personnel Only:** Installation of lighting components and piping must be performed by a certified electrician, following all national electric code and local building code requirements.
-  **IMPORTANT** **Equipment Protection:** Install the power supply and driver in a location protected from humidity, high temperatures, and water. Do not install inside Sauna as this will cause equipment failure.
-  **IMPORTANT** **Wall Support:** Ensure the wall that the Himalayan Salt Feature will be installed on will be able to support the weight of the salt feature. See page #5 for total load.
-  **CAUTION** **Sharp Objects:** Stainless Steel mounting channel has sharp edges and should be handled with care. It is recommended to wear cut resistant gloves when handling channel.
-  **IMPORTANT** The steps provided in this manual are meant as a guide and may differ based off the install. It is important that the installer fully understands these instructions to be able to make any necessary changes to accommodate the install.
- **Himalayan Salt:**
  - **Humidity:** Himalayan Salt is a natural element and will absorb humidity. In higher humidity rooms this may become more visible.
  - **Salt Crystals:** Over time, salt crystals may form on the surface of the bricks, especially in higher humidity rooms. This is normal and can simply be wiped off.
  - **Salt Color:** Himalayan Salt is a natural element. The color of each is listed as “Pink” but can vary, including lighter or darker shades. This variation is a natural characteristic of the salt.
- **LED Handling Precautions:**
  - **Uncoil LED Before Powering:** Do not connect power to the LED light while it is still attached to the spool or coiled up. Unwind the light completely before powering it on.
  - **Avoid Damage:** Refrain from folding or twisting the LED light, as this can cause physical damage to the LEDs and lead to malfunctions.

### Electrical Requirements

Always disconnect power from the system at the circuit breaker before performing any electrical installation or maintenance.



- **Power Source:** The lighting system requires a 120VAC power source.
- **Qualified Electrician:** A certified electrician should determine the appropriate electrical outlet type, box configuration, and necessary wiring to ensure compatibility and safety.
- **Electrical Safety:** Utilizing improper voltage or making incorrect electrical connections can damage system components and void the warranty.

## Required Tools / Material



**Tape Measure**



**Level**

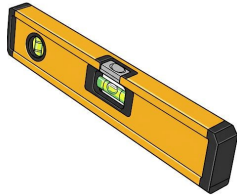

**Square**



**Hammer**



**Circular Saw  
(or table saw)**



**Drill/Driver**



**Ladder**



**Gloves  
(cut resistant)**



**Safety Glasses**



---

## Required Building Material

**2x4 Board**



**Hardwood Plywood  
(min 3/4")**



**3/4" Lath Screw**



# Specifications



Power Supplies							
Rated Power	Input Voltage	Output Voltage	AC Current	DC Current	Operating Temperature	IP Rating	Certification
90 Watt	120 VAC	24V DC	1.3A	3.75A	-22°F to 158°F	IP20	UL / CE / FCC
120 Watt	120 VAC	24V DC	1.4A	5A	-22°F to 158°F	IP20	UL / CE / FCC
160 Watt	120 VAC	24V DC	1.85	6.67A	-22°F to 158°F	IP20	UL / CE / FCC

Driver								
	Input Voltage	Output Voltage	Rated Out Current	Max Output Power	Light Capacity	Operating Temperature	IP Rating	Certification
Driver	24 VDC	12-24 VDC	5CH, 3A/CH	5CH x 72W	4 Lights / 25' (per driver)	-22°F to 131°F	IP20	UL / CE / FCC

Dimming Control								
	Operating Voltage	Power Consumption	Dimming Range	Signal Distance	Zones	Operating Temperature	IP Rating	Certification
Dimming Control	3 VDC (CR2032)	5mA	1% - 100%	98FT	1 Zone Single Color	-22°F to 131°F	IP20	UL / CE / FCC

White LED Light (single light)							
	Length	Operating Voltage	Wattage	Lumens	Kelvin Temperature	Operating Temperature	Certification
White LED Strip	4FT	24 VDC	12W (3W per foot)	313 per ft	3500K	-13°F to 230°F	ETL / SGS

Salt Feature Specifications									
	Small Salt Feature 4" x 48"	Small Salt Feature 12" x 48"	Large Salt Feature 24" x 48"	Large Salt Feature 36" x 48"	Large Salt Feature 48" x 48"	Salt Wall 60" x 48"	Salt Wall 72" x 48"	Salt Wall 84" x 48"	Salt Wall 96" x 48"
Salt Feature Size (finished dimension)	4" x 48"	12-1/4" x 48"	24-5/8" x 48"	37" x 48"	49-3/8" x 48"	61-3/4" x 48"	74-1/8" x 48"	86-1/2" x 48"	98-7/8" x 48"
Framed Opening Size	6" x 54"	14-1/4" x 54"	26-5/8" x 54"	39" x 54"	51-3/8" x 54"	63-3/4" x 54"	76-1/8" x 54"	88-1/2" x 54"	100-7/8" x 54"
LED Strip Quantity	1	3	6	9	12	15	18	21	24
Total Wattage	12W	36W	72W	100W	144W	180W	216W	252W	288W
Salt Feature Weight	34lbs +/-	97lbs +/-	192lbs +/-	286lbs +/-	381lbs +/-	476lbs +/-	571lbs +/-	666lbs +/-	760lbs +/-

Himalayan Salt Brick			
Color	Material	Weight (per brick)	Dimensions
Pink	Natural Pink Himalayan Salt	5lbs	4"H x 8"L x 2"D
White	Natural White Himalayan Salt	5lbs	4"H x 8"L x 2"D

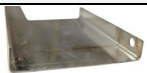
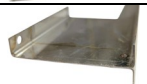
Stainless Steel Channel				
	Material	Weight	Dimensions	Profile
End Cap Channel	Stainless Steel	1.6lbs	4"H x 8"L x 2"D	
Mounting Channel	Stainless Steel	1.6lbs	4"H x 8"L x 2"D	

# Installation



## Phase 1: Framing

*Images Shown Below for Reference*

### 1. Stud Wall Framing:

- Identify the wall that the Salt Feature will be built on.
- The stud wall must be framed to provide adequate structural support for the weight of the salt feature. The use of 2x4 wood studs is recommended.
- Salt Feature will be built recessed in the stud wall and requires a framed out section to the size of the salt feature. This framed out section will be built the same as a window opening, (see figure #1).

**Note:** Refer to Specifications page #5 for the framed opening size.

Figure #1



### 2. Plywood Backer

- Once the wall is framed for the salt feature the plywood backing needs to be installed. This requires 2x4 boards and 3/4" hardwood plywood.
- Cut 2x4 boards to the width of the framed out opening and install horizontal in the opening at the back. It is recommended to install one board every 16", (see figure #2).
- Next take plywood and cut to dimension of framed opening. Place plywood into opening and screw to previously installed 2x4 boards, (see figure #3).

**Note:** If using multiple plywood sheets ensure seams are supported from behind with an additional 2x4 board.

Figure #2



Figure #3





# Installation



**Caution!** Use gloves when handling track



## Phase 2: Lighting Wire Runs

**Important:** Ensure all electrical is performed by a licensed electrician and complies with local codes

### 1. Wiring Runs:

- Each LED light will require a wire run, cables provided with each kit. Identify your kit and the number of LED light cables.
  - Run a minimum of 1" conduit from the salt feature to the location where the lighting power supply and controls will be installed (see figure #4).
- Note:** For larger salt features multiple conduit runs or larger size conduit may be necessary.
- Pull all 2-pin light cables from salt feature back to control system.



See Page #11 for Customizing Length of Himalayan Salt Feature

Images Shown Below for Reference

Figure #4



## Phase 3: Salt Block Track / LED Lighting

### 1. Salt Track:

- Position the End Cap Channel at the bottom of the framed opening. Secure it using 3/4" lath screws, inserting the screws through the pre-drilled holes on the channel.
- Note:** Framed opening is designed to be wider than the track to allow for wiring connections, (see figure #5).
- Uncoil one LED strip. Measure 2" vertically from the top edge of the installed channel and mark a level line. Remove the adhesive backing from the LED strip and carefully adhere it along the marked line ensuring the LED strip is centered.
- Note:** It is recommended to test each LED strip prior to installing.
- After adhering the LED strip, use a hammer to install mounting clips. Position one clip at each end of the strip (see figure #6)
  - Repeat the above steps for each additional row of salt track and LED light. See Phase 4 for salt brick install.

Figure #5



Figure #6

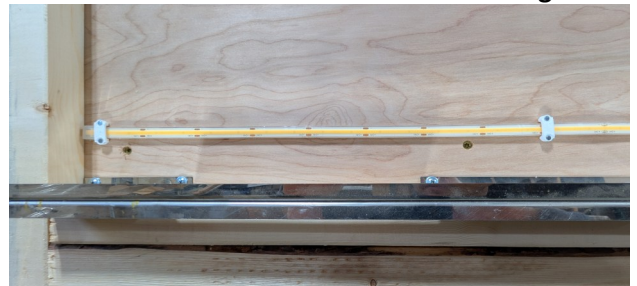

Figure #7



# Installation



**Caution! Use gloves when handling track**

## Phase 4: Himalayan Salt Bricks

### 1. Salt Bricks:

- Begin by placing two bricks onto the installed track, as shown in Figure #8. Note that each brick has notches that are off-center. Position the bricks so that the shorter notched section faces the wall, the longer section faces outward.



- Take the next section of salt track and carefully set it into the notches on the top of the placed salt bricks, as shown in Figure #9. Secure the track using 3/4" lath screws, inserting the screws through the pre-drilled holes on the channel. The rest of the track will get screwed down later.
- Continue sliding additional salt bricks into the row, (see figure #10).
- Once all salt bricks are positioned in the row, finish securing the track by installing the remaining screws.
- For the final, top row, install an End Cap Channel instead of a mounting a Mounting Channel. Secure using 3/4" lath screws.
- Repeat the above steps for each additional row of salt and track.

### 2. Cutting Salt Bricks (optional):

- The salt bricks can be arranged in various patterns, such as a staggered brick pattern. To achieve certain patterns, it may be necessary to cut some of the bricks (see figure #11).
- A wet tile saw is recommended for cutting salt bricks. It produces the cleanest cuts and minimizes dust.

**Note:** Alternatively a table saw or miter saw can be used. Due to the corrosive nature of salt, it is crucial the thoroughly clean the saw and remove all salt dust to prevent damage to saw.



*See Page #11 for Customizing Length of Himalayan Salt Feature*

*Images Shown Below for Reference*

Figure #8



Figure #9



Figure #10

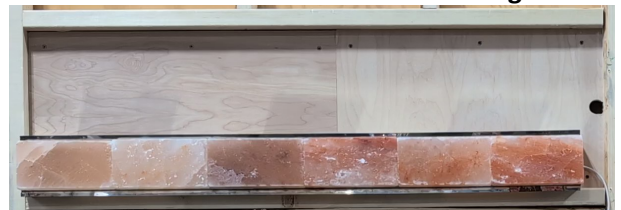

### Brick Pattern

Figure #11



Cut Bricks



# Installation



## Phase 5: Lighting Connections/Control System

### 1. LED Light Connections:

- After completing Phase 1 thru 4, begin connecting the LED lights to the light cables run in Phase 2.
- At each light take 1 light cable and connect it to the corresponding pigtail from the LED light, it is recommended to work either from the top down or bottom up to maintain organization, (see figure #12).

### 2. Control System

- The control system, including the power supply and control system, should be installed in a dry accessible location to prevent damage. It is important that the control system is not installed in the sauna room due to the high heat and humidity which can lead to equipment failure.
- Ensure there is a dedicated 120V electrical outlet rated for a minimum of 15amps. While a GFCI outlet can be used, it is not required.
- Carefully follow the wiring diagram provided to make all necessary connections at the driver and other control components.

**Note:** Refer to the diagrams on pages 13-17 for the specific setup that corresponds to your salt feature size.

- After making all connections, verify that they are secure both at the salt feature and control system location.
- Once all connections have been verified, plug in the power supply to the 120V outlet. Test the light function using the remote. Refer to page 12 for detailed instructions on control operation.

**Note:** If you encounter any issues with operation see troubleshooting page #22.

*Images Shown Below for Reference*

**Figure #12**



# Installation



## Phase 6: Wall Cladding / Furring Boards

### 1. Vapor Barrier

- After building the salt feature apply vapor barrier to entire wall surface. Ensure the vapor barrier extends to the edges of the salt feature on all sides.

**Note:** If any additional blocking is required for benching or other fixtures, install this before applying the vapor barrier.

### 2. Furring Boards

- Determine the desired orientation of the tongue and groove (T&G) wall boards. Create a minimum 1.5" standoff from the stud wall using furring strips. In this example the wall boards will be installed vertically (see figure #13).
- Install furring strips, ideally 2x4 boards, spaced approximately every 24".
- A furring strip must be installed at the top and bottom edges of the salt feature.

### 3. Wall Boards / T&G

- Once the furring strips are installed, gather the wall boards.
  - Begin installing wall boards from either the left or right side.
- Note:** Ensure the first wall board is perfectly plumb with the salt feature and periodically re-check plumb every few boards as you approach the salt feature.
- Depending on the specific wall boards used, it may be necessary to cut them to fit around the salt feature.

*Images Shown Below for Reference*

Figure #13



# Installation



**Only width can be modified. Salt Bricks, Track, and LED will need to be cut.**

## Custom Width

To modify the width of your Salt Feature follow the steps below for cutting the Salt Bricks, Track, and LED Strips.

### 1. LED Strip (Phase 3)

- LED strips can only be cut every 1.9" refer to Figure #14 for guidance.
- First determine the desired width for your salt feature.
- Then, divide the feature's desired width by 1.97" to calculate the number of cut points.

**Example:** For a 36" feature, divide 36" by 1.97", which equals 18.27". This gives you 18 cut points, resulting in a width of 35.46"

**Note:** The cut LED strip will be shorter than your desired salt feature width by no more than 2".

- After cutting the LED strip, apply silicone and install the new cap on the cut end.

### 2. Mounting Channel/End Caps (Phase 3)

**Warning: Sharp Edges. Wear Safety Glasses When Cutting.**

- For cutting the mounting channel and end cap, we recommend using either a circular saw or an angle grinder equipped with a blade specifically rated for cutting metal.
- Mark the channel at your desired width. This should be the total width of the salt feature and can be up to 1/2" shorter.

### 3. Salt Bricks (Phase 4)

- We recommend using a wet tile saw to cut the salt bricks.

**Note:** Alternatively a table saw or miter saw can be used. Due to the corrosive nature of salt, it is crucial to thoroughly clean the saw and remove all salt dust to prevent damage to saw.

- Secure the salt brick(s) and make a clean, straight cut at your determined width.

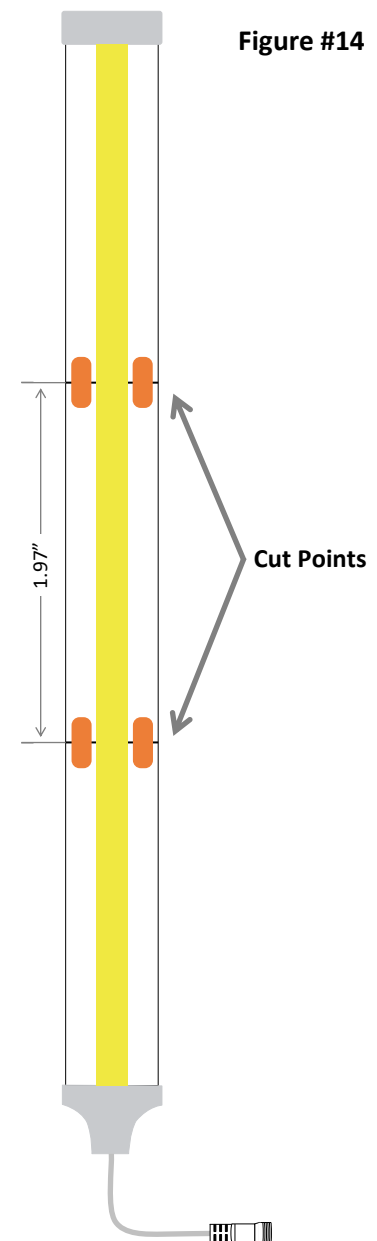
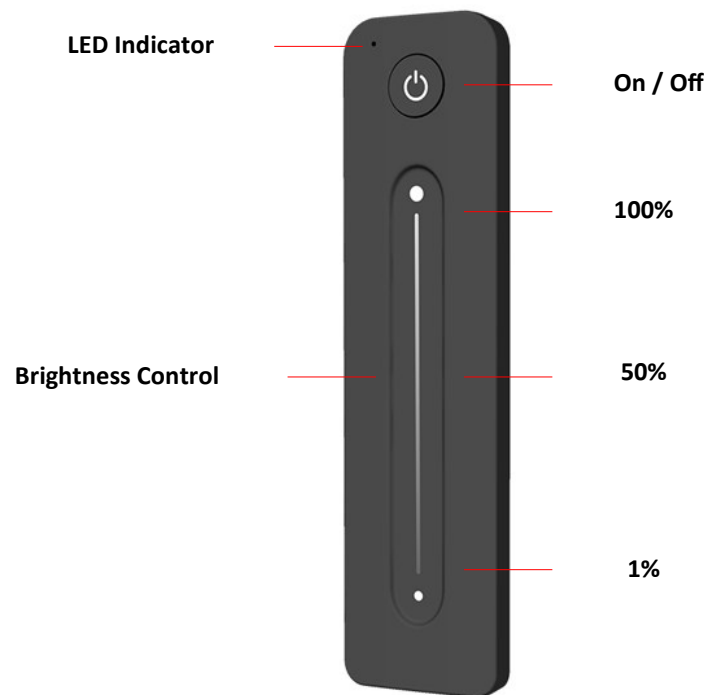

Figure #14

## Control Operation



Follow the steps below for control operation. After 30 seconds of inactivity the remote will enter sleep mode to preserve battery. To wake up the control, press On/Off button.



## Driver & Remote Programming

**Note:** The RF Driver comes preprogrammed. Follow steps below if programming is needed.

1. Press and hold the Match button for about 8 seconds or until the Run Indicator light turns White.
2. Release the Match button to save.

**Note:** The indicator may flash purple. To exit, short press the Match button.

3. On the driver, short press the Match button once, then quickly press the power button on the remote. The Run indicator light on the driver will rapidly flash, indicating successful pairing. Repeat this step for each driver.

**Note:** If you encounter any issues during startup and testing, proceed to the troubleshooting steps.

# Connection Diagrams

## Replacement Parts



Refer to your order for your Salt Feature Size

### 4" x 48" Small Salt Feature

	1	2	3	4	5	6	7	8	9	10	11
Description	Salt Brick (not pictured)	4' End Cap Channel	4' White LED Strip	RF Driver	Dimming Remote	90W Power Supply	AC Power Cable (for power supply)	2-Pin Pigtail	30' Light Cable	LED Mounting Clip (not pictured)	LED Cap (not pictured)
Quantity	6 (+1 extra)	2	1	1	1	1	1	1	1	4	1
Part Number	127839	128142	BP031178	BP031108	BP031111	BP031137	BP031132	BP031073	BP031077	BP031188	BP031185

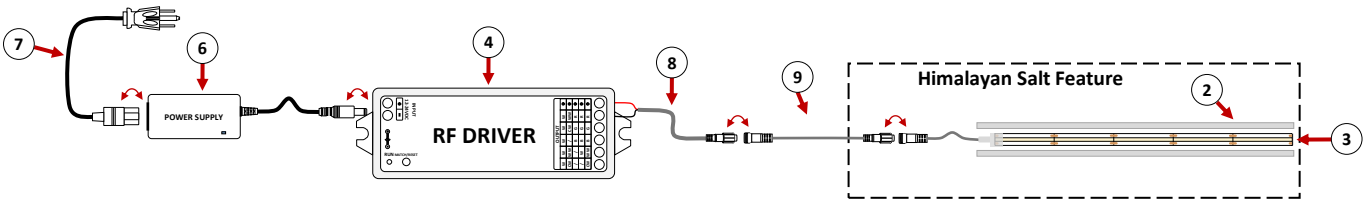
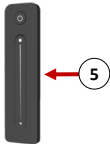

### 12" x 48" Small Salt Feature

	1	2	3	4	5	6	7	8	9	10	11	12	13
Description	Salt Brick (not pictured)	4' Mounting Channel	4' End Cap Channel	4' White LED Strip	RF Driver	Dimming Remote	90W Power Supply	AC Power Cable (for power supply)	2-Pin Pigtail	30' Light Cable	2-Pin Splitter Cable	LED Mounting Clip (not pictured)	LED Cap (not pictured)
Quantity	18 (+2 extra)	2	2	3	1	1	1	1	1	3	1	12	3
Part Number	127839	128035	128142	BP031178	BP031108	BP031111	BP031137	BP031132	BP031073	BP031077	BP031075	BP031188	BP031185

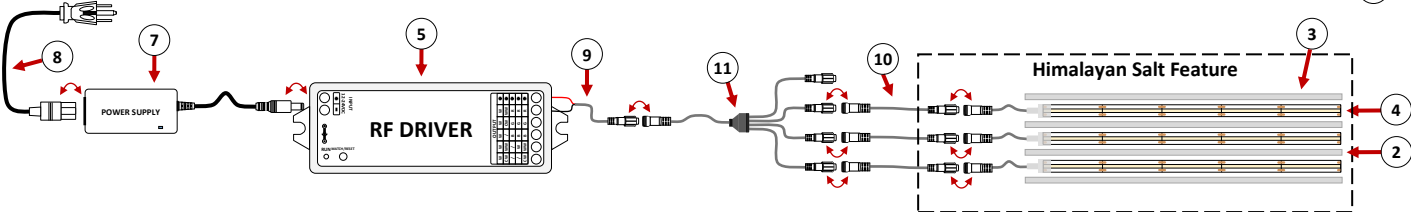

### 24" x 48" Large Salt Feature

	1	2	3	4	5	6	7	8	9	10	11	12	13	14
Description	Salt Block (not pictured)	4' Mounting Channel	4' End Cap Channel	4' White LED Strip	RF Driver	Dimming Remote	90W Power Supply	AC Power Cable (for power supply)	2-Pin Pigtail	30' Light Cable	2-Pin Splitter Cable	2-Way DC Barrel Splitter	LED Mounting Clip (not pictured)	LED Cap (not pictured)
Quantity	36 (+4 extra)	5	2	6	2	1	1	1	2	6	2	1	24	6
Part Number	127839	128035	128142	BP031178	BP031108	BP031111	BP031137	BP031132	BP031073	BP031077	BP031075	BP031114	BP031188	BP031185

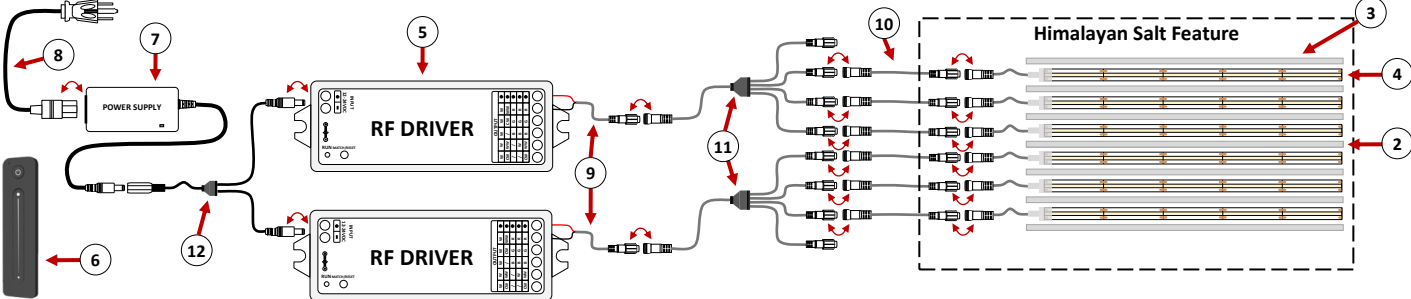



# Connection Diagrams

## Replacement Parts



Refer to your order for your Salt Feature Size

### 36" x 48" Large Salt Feature

	1	2	3	4	5	6	7	8	9	10	11	12	13	14
Description	Salt Block (not pictured)	4' Mounting Channel	4' End Cap Channel	4' White LED Strip	RF Driver	Dimming Remote	120W Power Supply	AC Power Cable (for power supply)	2-Pin Pigtail	30' Light Cable	2-Pin Splitter Cable	4-Way DC Barrel Splitter	LED Mounting Clip (not pictured)	LED Cap (not pictured)
Quantity	54 (+5 extra)	8	2	9	3	1	1	1	3	9	3	1	36	9
Part Number	127839	128035	128142	BP031178	BP031108	BP031111	BP031135	BP031132	BP031073	BP031077	BP031075	BP031138	BP031188	BP031185

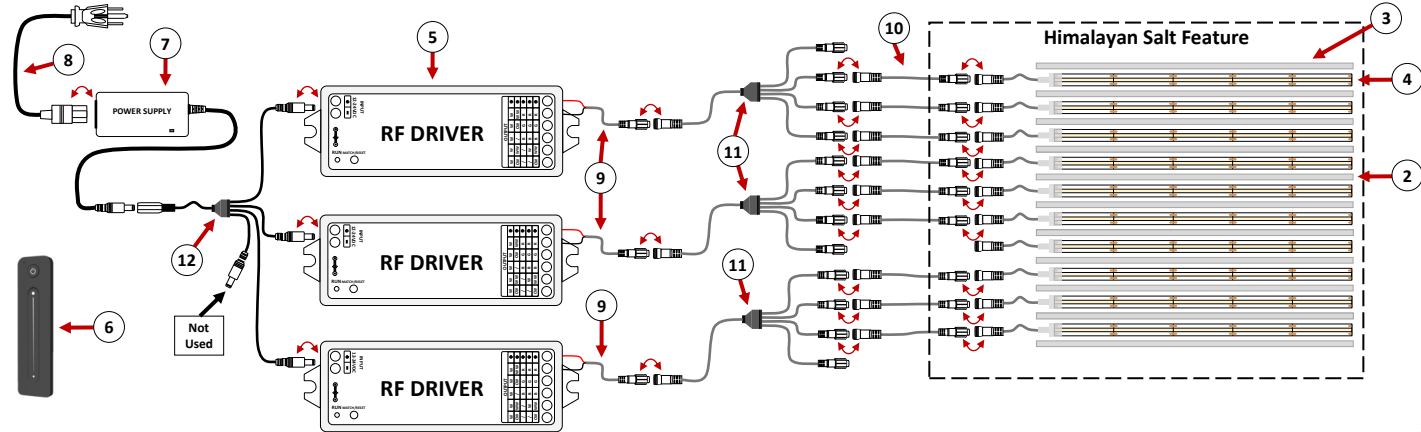

### 48" x 48" Large Salt Feature

	1	2	3	4	5	6	7	8	9	10	11	12	13	14	15
Description	Salt Block (not pictured)	4' Mounting Channel	4' End Cap Channel	4' White LED Strip	RF Driver	Dimming Remote	160W Power Supply	AC Power Cable (for power supply)	2-Pin Pigtail	30' Light Cable	2-Pin Splitter Cable	4-Way DC Barrel Splitter	DC Barrel Adapter	LED Mounting Clip (not pictured)	LED Cap (not pictured)
Quantity	72 (+6 extra)	11	2	12	3	1	1	1	3	12	3	1	1	48	12
Part Number	127839	128035	128142	BP031178	BP031108	BP031111	BP031145	BP031132	BP031073	BP031077	BP031075	BP031138	DCPLUG-R7BF-P1M	BP031188	BP031185

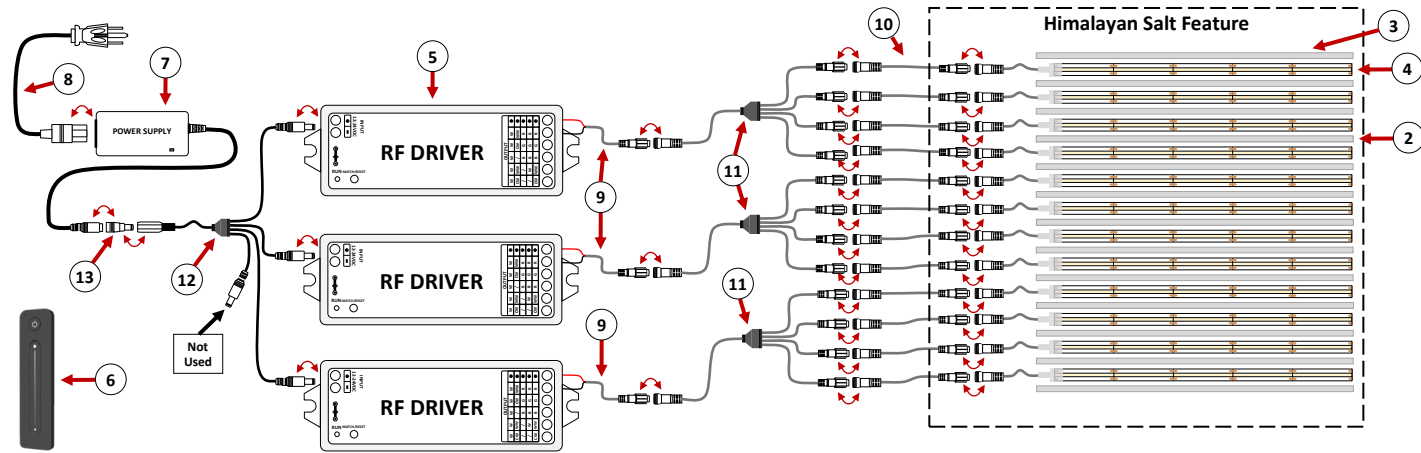

# Connection Diagrams

## Replacement Parts



Refer to your order for your Salt Feature Size

60" x 48" Large Salt Feature

	1	2	3	4	5	6	7	8	9	10	11	12	13	14
Description	Salt Brick (not pictured)	4' Mounting Channel	4' End Cap Channel	4' White LED Strip	RF Driver	Dimming Remote	120W Power Supply	AC Power Cable (for power supply)	2-Pin Pigtail	30' Light Cable	2-Pin Splitter Cable	2-Way DC Barrel Splitter	LED Mounting Clip (not pictured)	LED Cap (not pictured)
Quantity	90 (+8 extra)	14	2	15	4	1	2	2	4	15	4	2	60	15
Part Number	127839	128035	128142	BP031178	BP031108	BP031111	BP031135	BP031132	BP031073	BP031077	BP031075	BP031114	BP031188	BP031185

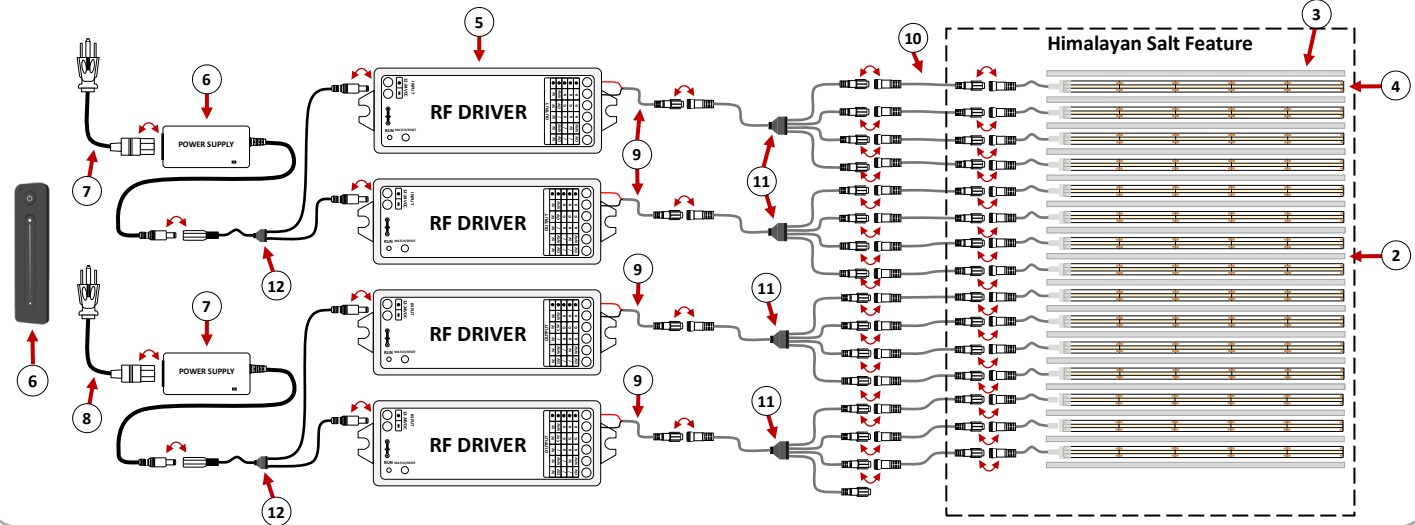

72" x 48" Large Salt Feature

	1	2	3	4	5	6	7	8	9	10	11	12	13	14	15	16
Description	Salt Brick (not pictured)	4' Mounting Channel	4' End Cap Channel	4' White LED Strip	RF Driver	Dimming Remote	160W Power Supply	AC Power Cable (for power supply)	2-Pin Pigtail	30' Light Cable	2-Pin Splitter Cable	2-Way DC Barrel Splitter	4-Way DC Barrel Splitter	DC Barrel Adapter	LED Mounting Clip (not pictured)	LED Cap (not pictured)
Quantity	108 (+9 extra)	17	2	18	5	1	2	2	5	18	5	1	1	1	72	18
Part Number	127839	128035	128142	BP031178	BP031108	BP031111	BP031145	BP031132	BP031073	BP031077	BP031075	BP031114	BP031138	DCPLUG-R7BF-P1M	BP031188	BP031185

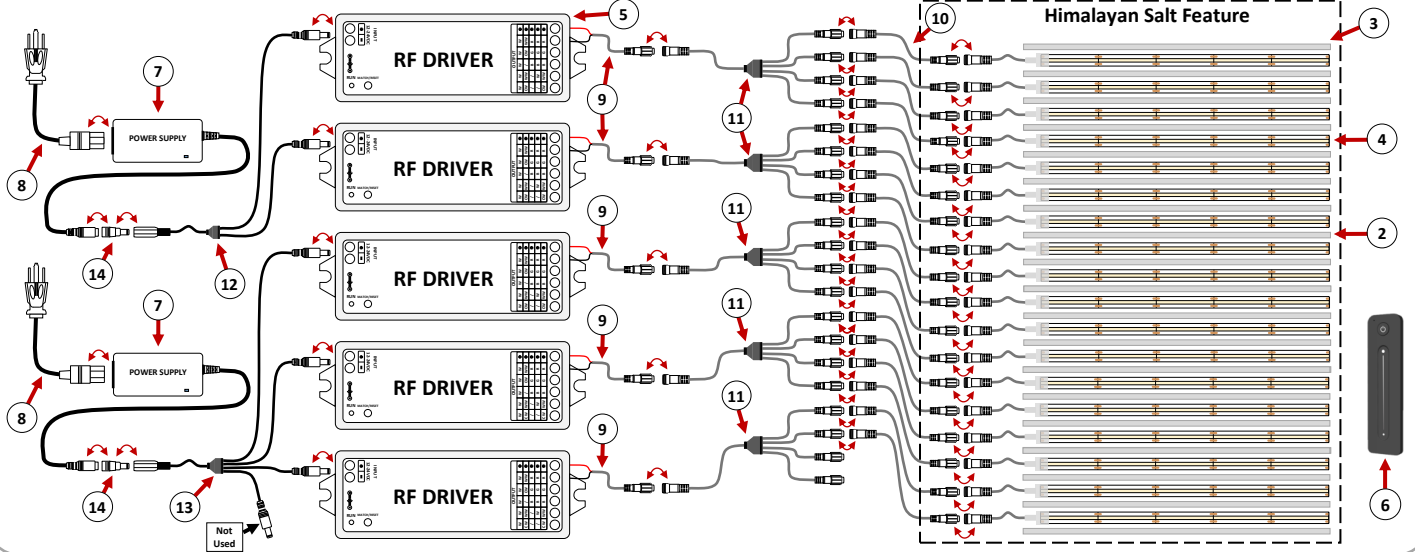

# Connection Diagrams

## Replacement Parts



Refer to your order for your Salt Feature Size

84" x 48" Large Salt Feature

	1	2	3	4	5	6	7	8	9	10	11	12	13	14	15
Description	Salt Brick (not pictured)	4' Mounting Channel	4' End Cap Channel	4' White LED Strip	RF Driver	Dimming Remote	160W Power Supply	AC Power Cable (for power supply)	2-Pin Pigtail	30' Light Cable	2-Pin Splitter Cable	4-Way DC Barrel Splitter	DC Barrel Adapter	LED Mounting Clip (not pictured)	LED Cap (not pictured)
Quantity	126 (+10 extra)	20	2	21	6	1	2	2	6	21	5	2	2	84	21
Part Number	127839	128035	128142	BP031178	BP031108	BP031111	BP031145	BP031132	BP031073	BP031077	BP031075	BP031138	DCPLUG-R7BF-P1M	BP031188	BP031185

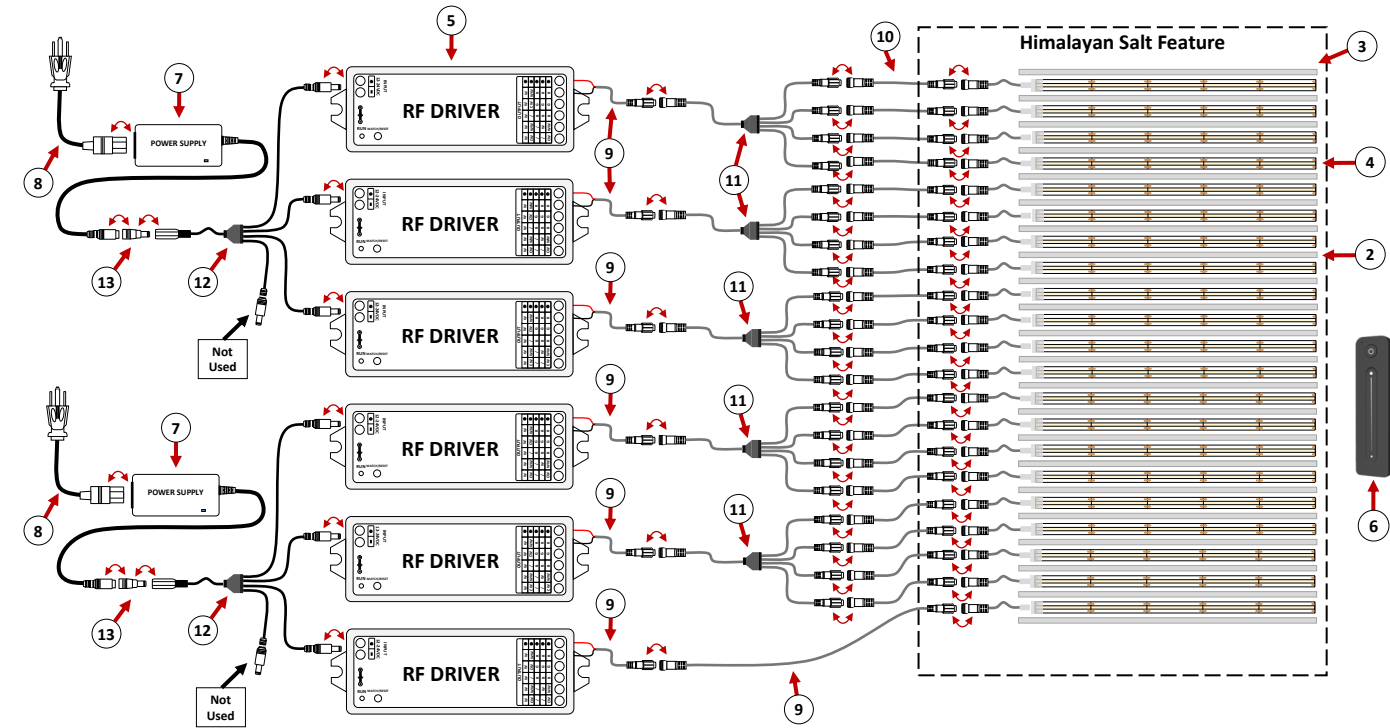

# Connection Diagrams

## Replacement Parts



Refer to your order for your Salt Feature Size

96" x 48" Large Salt Feature

	1	2	3	4	5	6	7	8	9	10	11	12	13	14	15
Description	Salt Brick (not pictured)	4' Mounting Channel	4' End Cap Channel	4' White LED Strip	RF Driver	Dimming Remote	160W Power Supply	AC Power Cable (for power supply)	2-Pin Pigtail	30' Light Cable	2-Pin Splitter Cable	4-Way DC Barrel Splitter	DC Barrel Adapter	LED Mounting Clip (not pictured)	LED Cap (not pictured)
Quantity	144 (+12 extra)	23	2	24	6	1	2	2	6	24	6	2	2	96	24
Part Number	127839	128035	128142	BP031178	BP031108	BP031111	BP031145	BP031132	BP031073	BP031077	BP031075	BP031138	DCPLUG-R7BF-P1M	BP031188	BP031185

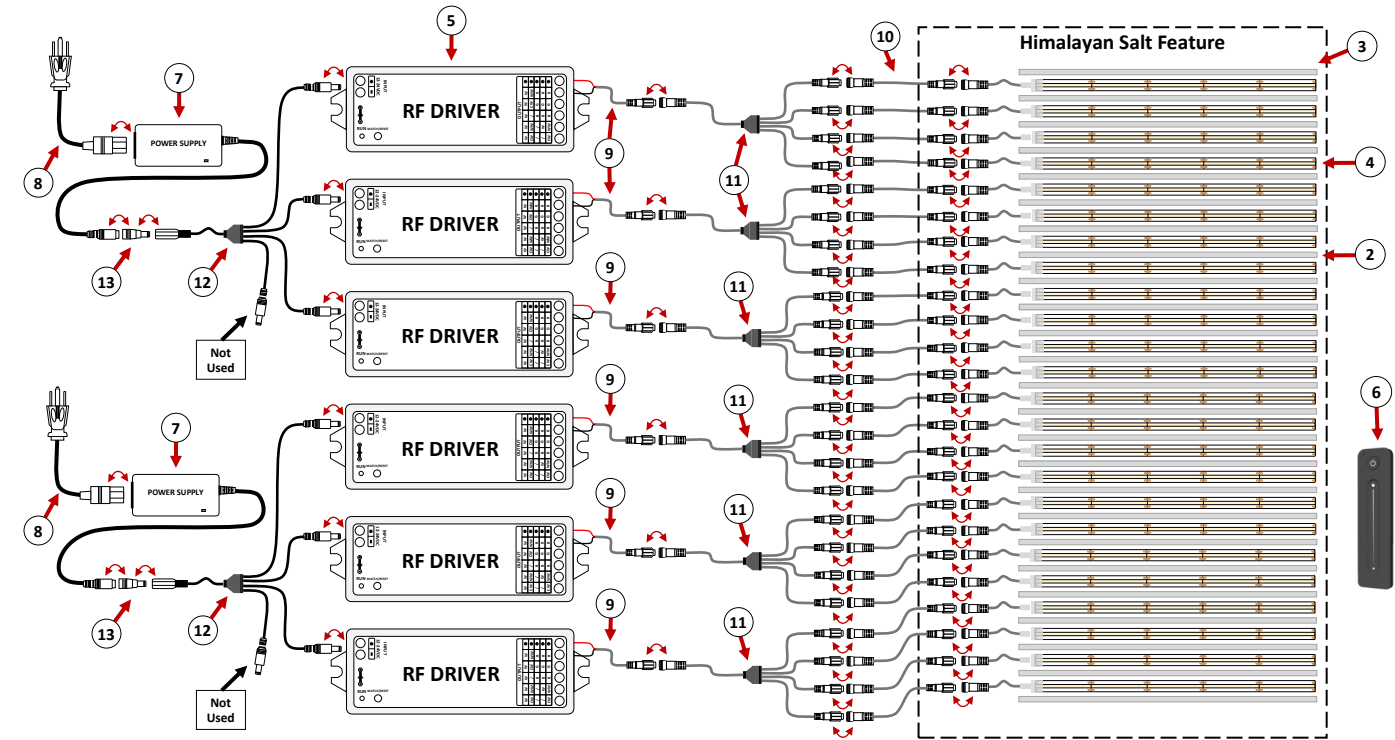

## Small Salt Feature Framing



**4" x 48" Small Salt Feature**

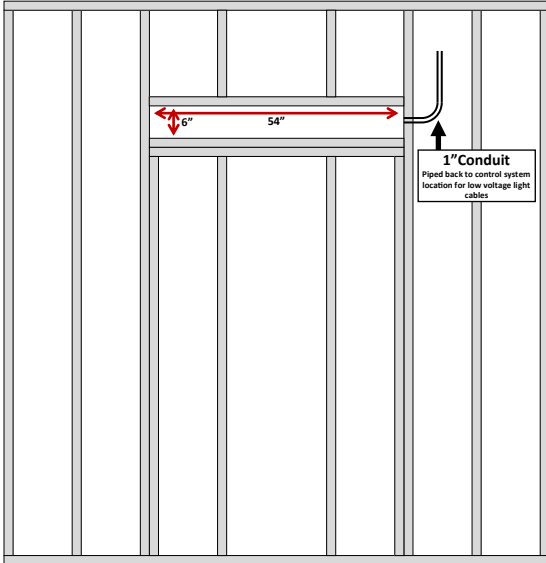

**12" x 48" Small Salt Feature**

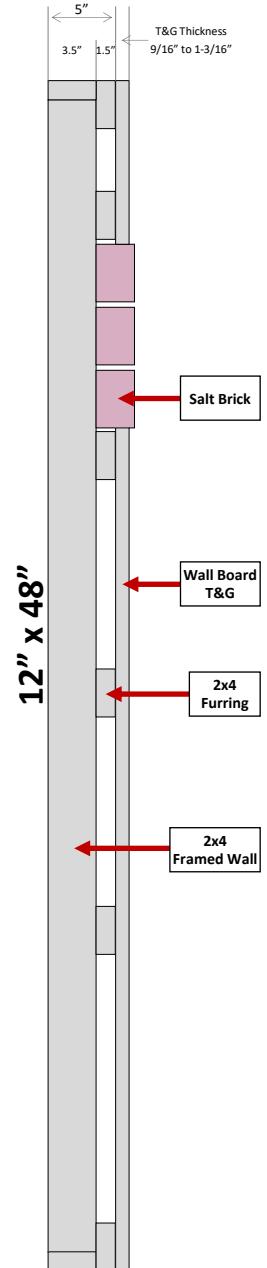
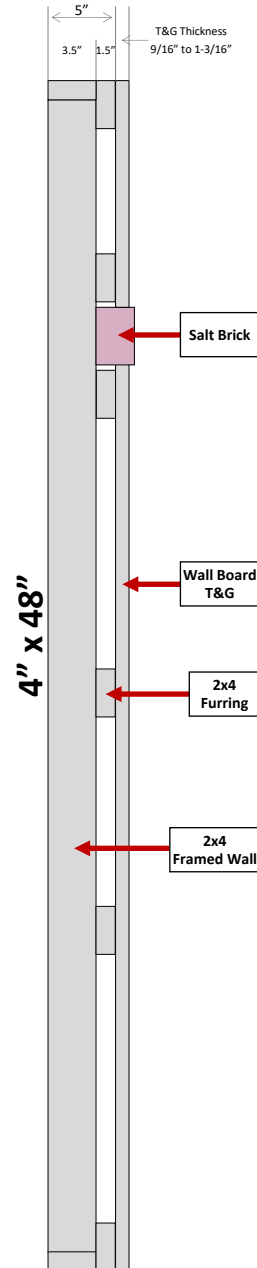
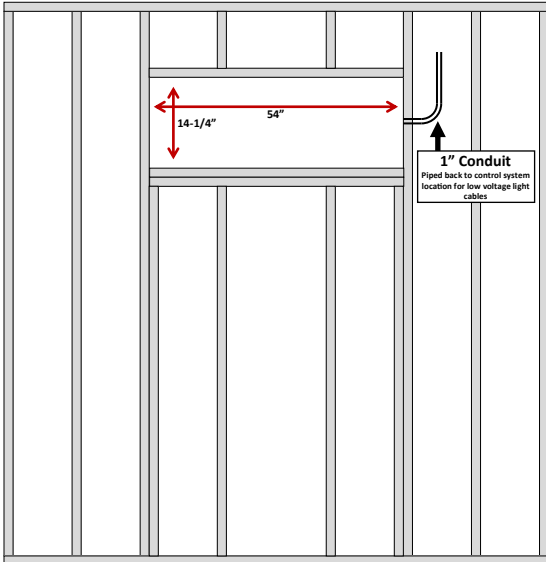

Follow all local building codes for framing.

Above diagrams are for reference only

REV: 1.0\_05/2025



# Large Salt Feature Framing



**24" x 48" Large Salt Feature**

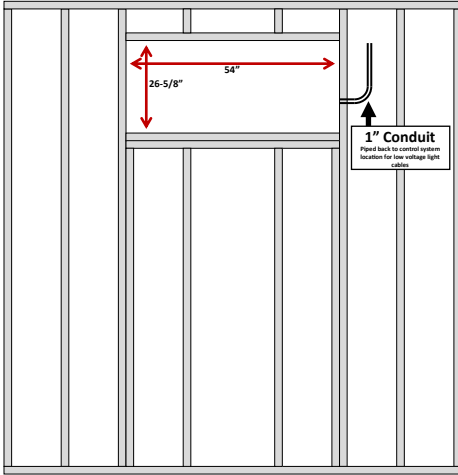

**36" x 48" Large Salt Feature**

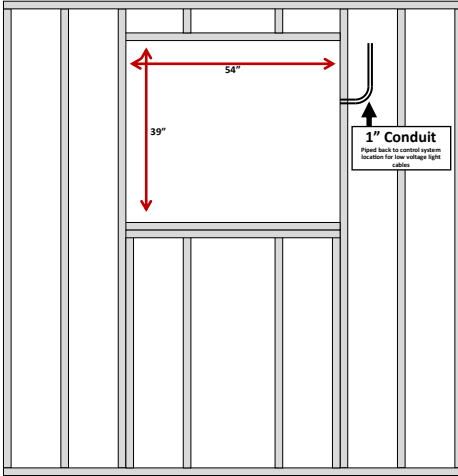

**48" x 48" Large Salt Feature**

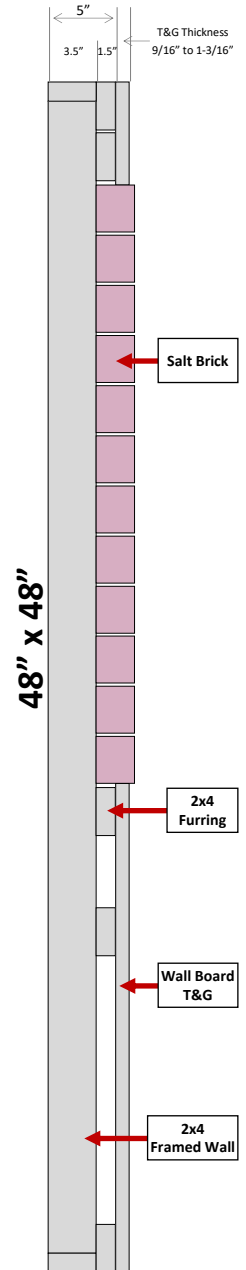
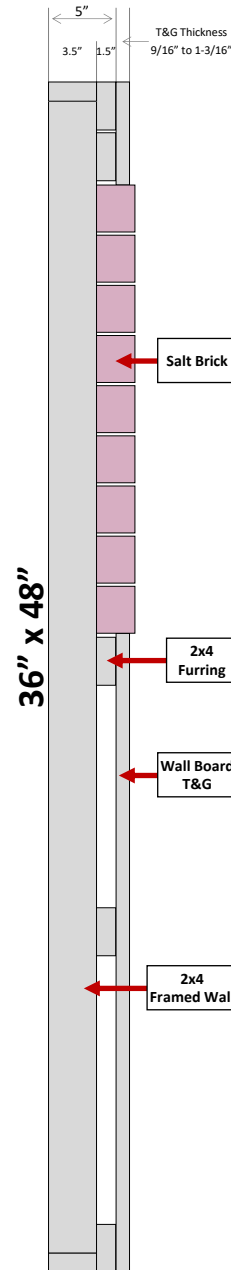
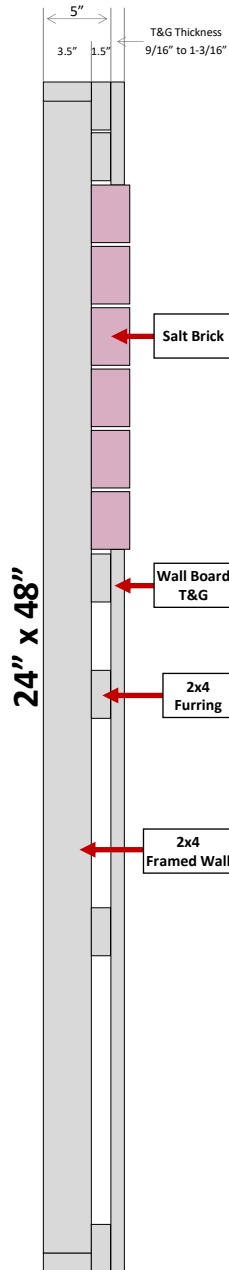
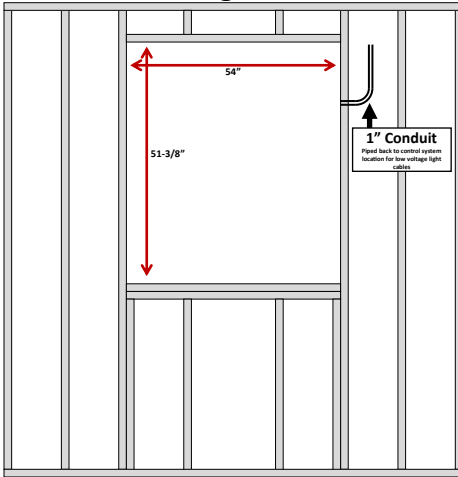

Follow all local building codes for framing.  
Above diagrams are for reference only

# Salt Wall Framing



**70" x 48" Salt Wall**

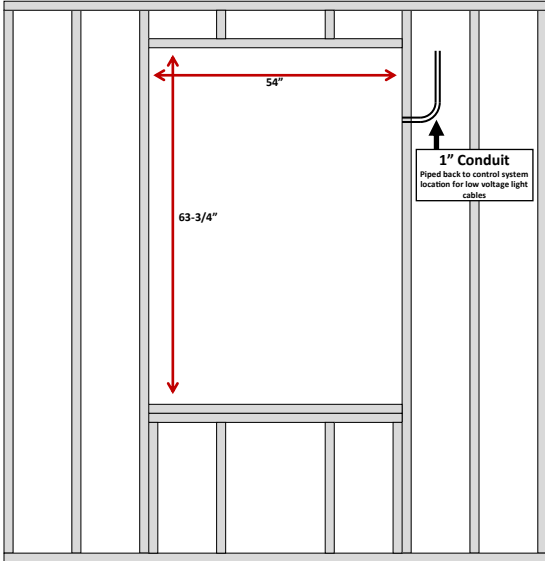

**72" x 48" Salt Wall**

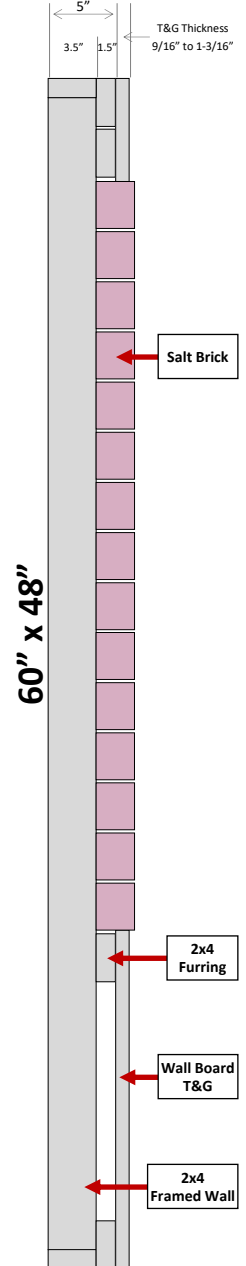
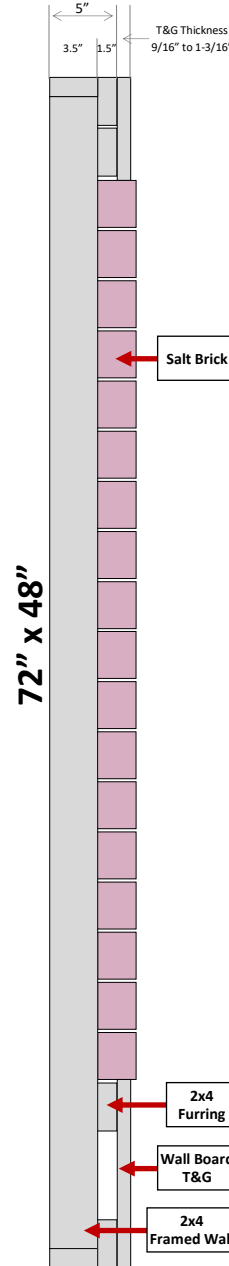
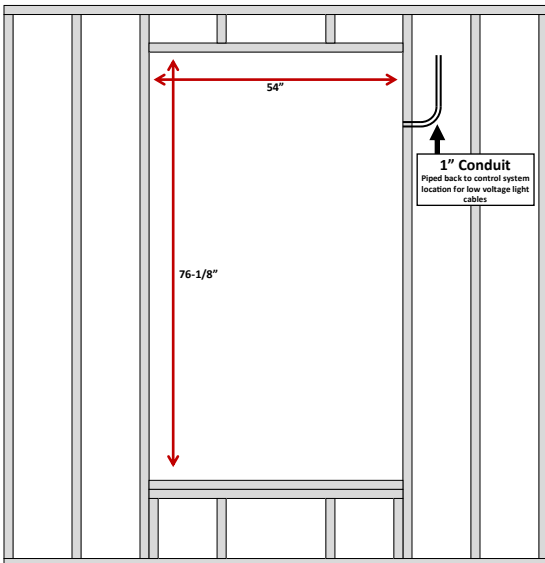

Follow all local building codes for framing.  
Above diagrams are for reference only

# Salt Wall Framing



**84" x 48" Salt Wall**

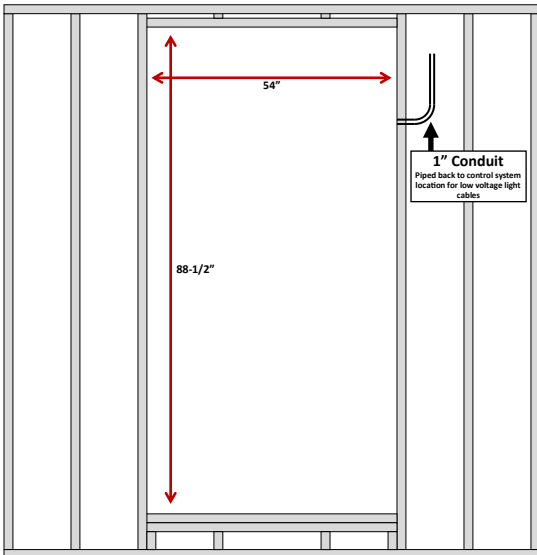

**96" x 48" Salt Wall**

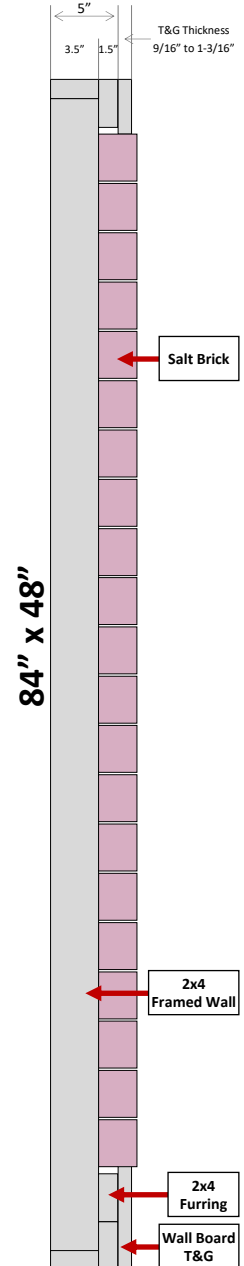
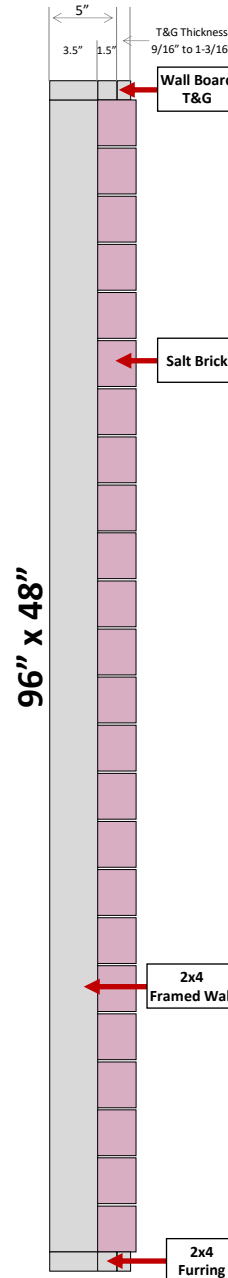
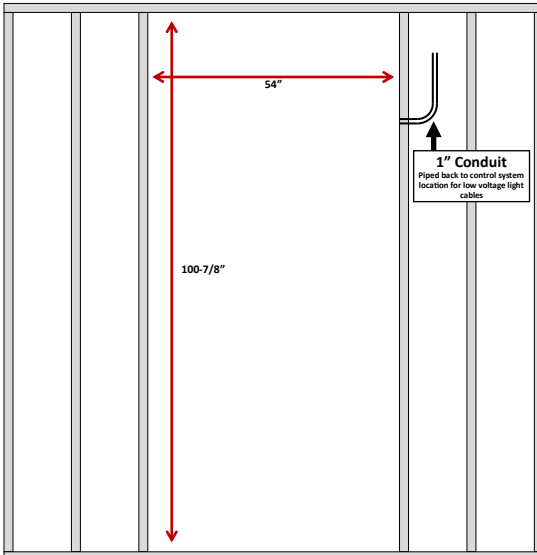

Follow all local building codes for framing.  
Above diagrams are for reference only

REV: 1.0\_05/2025

## Troubleshooting

### No Power

- **Verify Outlet Voltage:** Use a voltage tester to confirm that the outlet is providing the correct voltage (approximately 120VAC).
- **Check Circuit Breaker:** If there is no voltage at the outlet, inspect the circuit breaker in the electrical panel to ensure it has not tripped. Reset the breaker if necessary.
- **Inspect Power Connections:** Carefully verify that all power connections are secure and correctly connected:
  - **Power supply connection:** Check the connection between the power supply and the 120V power source.
  - **DC connections:** Check the connection between the DC plug from the power supply and DC splitter.

### Power Present, Lights Not Illuminating

- **Check Driver Output Connections:** Ensure that the cable from the drivers output (pigtail cable) is securely connected.
- **Check 4-Way Light Cable Connection:** Verify that the 4-way light cable is securely connected.
- **Check 30' Light Cable Connections:** Confirm that all 30' light cables connecting to each light are securely connected at both ends.
- **Test Individual LED Strips:** To isolate the problem, test each LED strip individually by connecting it directly to the power supply.
  - **Note:** To test an individual LED light, disconnect the 4-way DC splitter and connect the 30ft cable directly to the pigtail lead on the power supply.
- **Verify Remote Pairing:** Confirm that the RF remote is properly paired with the driver, see page 11 for pairing.

### Lights On, No Function from Control

- **Check Remote Battery:** Verify that the battery in the remote is inserted properly.
- **Battery Level Low:** If the battery level is low, replace it with a new battery.
- **Verify Remote Pairing:** Confirm that the RF remote is properly paired with the driver, see page 11 for pairing.
- **Check Remote Distance:** Ensure that the distance between the remote and the driver is within the specified range (98FT).

### Resetting Driver

The driver should not require resetting under normal circumstances. If a reset is necessary, proceed with the following steps.

- **Verify Driver Power:** Ensure that the driver is receiving power.
- **Initiate Reset:** Press and hold the Match button on the driver for 10-15 seconds until the blue LED indicator begins to flash rapidly.
  - **Note:** Resetting the driver will erase any existing remote pairings, requiring you to re-pair the remote (see page 11).



Technical Support  
(224) 253-5909

© 2025 Bathing Brands, Inc.

REV: 1.1\_06/2025