



## Universal Himalayan Salt Feature



### Installation and Operation Manual

# Contents







<a href="#"><u>Safety &amp; Warnings</u></a>	-----	3
<a href="#"><u>Required Tools / Material</u></a>	-----	4
<a href="#"><u>Specifications</u></a>	-----	5
<a href="#"><u>Installation</u></a>	-----	6 - 11
<a href="#"><u>Custom Length</u></a>	-----	11
<a href="#"><u>Connection Diagrams</u></a>	-----	12
<a href="#"><u>Replacement Parts</u></a>	-----	
<a href="#"><u>Framing Dimensions</u></a>	-----	13 - 15
<a href="#"><u>Troubleshooting</u></a>	-----	16

## SAFETY & WARNINGS



### PLEASE READ THIS MANUAL IN ITS ENTIRETY PRIOR TO INSTALLATION!

-  **IMPORTANT** **Qualified Personnel Only:** Installation of lighting components and piping must be performed by a certified electrician, following all national electric code and local building code requirements.
-  **IMPORTANT** **Equipment Protection:** Install the power supply and driver in a location protected from humidity, high temperatures, and water. Do not install inside Sauna as this will cause equipment failure.
-  **IMPORTANT** **Wall Support:** Ensure the wall that the Himalayan Salt Feature will be installed on will be able to support the weight of the salt feature. See page #5 for total load.
-  **CAUTION** **Sharp Objects:** Stainless Steel mounting channel has sharp edges and should be handled with care. It is recommended to wear cut resistant gloves when handling channel.
-  **IMPORTANT** The steps provided in this manual are meant as a guide and may differ based off the install. It is important that the installer fully understands these instructions to be able to make any necessary changes to accommodate the install.
- **Himalayan Salt:**
  - **Humidity:** Himalayan Salt is a natural element and will absorb humidity. In higher humidity rooms this may become more visible.
  - **Salt Crystals:** Over time, salt crystals may form on the surface of the bricks, especially in higher humidity rooms. This is normal and can simply be wiped off.
  - **Salt Color:** Himalayan Salt is a natural element. The color of each is listed as “Pink” but can vary, including lighter or darker shades. This variation is a natural characteristic of the salt.
- **LED Handling Precautions:**
  - **Uncoil LED Before Powering:** Do not connect power to the LED light while it is still attached to the spool or coiled up. Unwind the light completely before powering it on.
  - **Avoid Damage:** Refrain from folding or twisting the LED light, as this can cause physical damage to the LEDs and lead to malfunctions.

### Electrical Requirements

Always disconnect power from the system at the circuit breaker before performing any electrical installation or maintenance.



- **Power Source:** The lighting system requires a 120VAC power source.
- **Qualified Electrician:** A certified electrician should determine the appropriate electrical outlet type, box configuration, and necessary wiring to ensure compatibility and safety.
- **Electrical Safety:** Utilizing improper voltage or making incorrect electrical connections can damage system components and void the warranty.

## Required Tools / Material



**Tape Measure**



**Level**

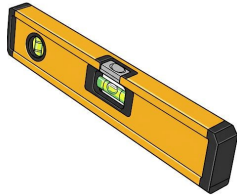

**Square**



**Hammer**



**Circular Saw  
(or table saw)**



**Drill/Driver**



**Ladder**



**Gloves  
(cut resistant)**



**Safety Glasses**



---

## Required Building Material

**2x4 Board**



**Hardwood Plywood  
(min 3/4")**



**3/4" Lath Screw**



## Specifications



Salt Feature Specifications				
Salt Feature Size (finished dimension)	Framed Opening Size	LED Strip Quantity	Total Wattage	Salt Feature Weight
<b>4" x 48"</b> SKU: BDL-129111	6" x 54"	1	12W	34lbs +/-
<b>12-1/4" x 48"</b> SKU: BDL-129112	14-1/4" x 54"	3	36W	97lbs +/-
<b>16-3/8" x 48"</b> SKU: BDL-129113	18-3/8" x 54"	4	48W	128lbs +/-

Power Supply							
Rated Power	Input Voltage	Output Voltage	AC Current	DC Current	Operating Temperature	IP Rating	Certification
<b>90 Watt</b>	120 VAC	24VDC	1.3A	3.75A	-22°F to 158°F	IP20	UL / CE / FCC

LED Light (single light)							
	Length	Operating Voltage	Wattage	Lumens	Kelvin Temperature	Operating Temperature	Certification
<b>White LED Strip</b>	4FT	24 VDC	12W (3W per foot)	396	3500K	-13°F to 230°F	ETL / SGS

Himalayan Salt Brick			
Color	Material	Weight (per brick)	Dimensions
<b>Pink</b>	Natural Himalayan Salt	5lbs	4"H x 8"L x 2"D

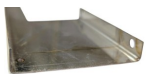
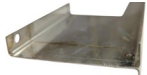
Stainless Steel Channel				
	Material	Weight	Dimensions	Profile
<b>End Cap Channel</b>	Stainless Steel	1.6lbs	4"H x 8"L x 2"D	
<b>Mounting Channel</b>	Stainless Steel	1.6lbs	4"H x 8"L x 2"D	

# Installation



## Phase 1: Framing

*Images Shown Below for Reference*

### 1. Stud Wall Framing:

- Identify the wall that the Salt Feature will be built on.
- The stud wall must be framed to provide adequate structural support for the weight of the salt feature. The use of 2x4 wood studs is recommended.
- Salt Feature will be built recessed in the stud wall and requires a framed out section to the size of the salt feature. This framed out section will be built the same as a window opening, (see figure #1).

**Note:** Refer to Specifications on page 5 for the framed opening size.

Figure #1



### 2. Plywood Backer

- Once the wall is framed for the salt feature the plywood backing needs to be installed. This requires 2x4 boards and 3/4" hardwood plywood.
- Cut 2x4 boards to the width of the framed out opening and install horizontal in the opening at the back. It is recommended to install one board every 16", (see figure #2).
- Next take plywood and cut to dimension of framed opening. Place plywood into opening and screw to previously installed 2x4 boards, (see figure #3).

**Note:** If using multiple plywood sheets ensure seams are supported from behind with an additional 2x4 board.

Figure #2



Figure #3





## Installation



**Caution!** Use gloves when handling track

### Phase 2: Lighting Wire Runs

**Important:** Ensure all electrical is performed by a licensed electrician and complies with local codes

#### 1. Wiring Runs:

- Each LED light will require a wire run for the provided cable with each kit. Identify your kit and the number of LED light cables.
  - Run a minimum of 1" conduit from the salt feature to the location where the lighting power supply and controls will be installed (see figure #4). Do not install power supply in sauna room. Refer to page 9 for installation and connection.
- Note:** For larger salt features multiple conduit runs or larger size conduit may be necessary.
- Pull all 2-pin light cables from salt feature back to control system.

### Phase 3: Salt Block Track / LED Lighting

#### 1. Salt Track / LED Lighting:

- Position the End Cap Channel at the bottom of the framed opening. Secure it using 3/4" lath screws, inserting the screws through the pre-drilled holes on the channel.
- Note:** Framed opening is designed to be wider than the track to allow for wiring connections, (see figure #5).
- Uncoil one LED strip. Measure 2" vertically from the top edge of the installed channel and mark a level line. Remove the adhesive backing from the LED strip and carefully adhere it along the marked line ensuring the LED strip is centered.
- Note:** It is recommended to test each LED strip prior to installing.
- After adhering the LED strip, use a hammer to install mounting clips. Position one clip at each end of the strip and then a minimum every 12" (see figure #6).
  - Repeat the above steps for each additional row of salt track and LED light. See Phase 4 for salt brick install.



See Page #11 for Customizing Length of Himalayan Salt Feature

Images Shown Below for Reference

Figure #4



#### Channel Profiles

**End Cap Channel**  
Installed Bottom and Top of Salt Feature

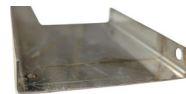

**Mounting Channel**  
Installed Between Each Row of Salt

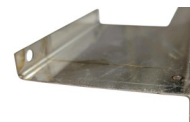
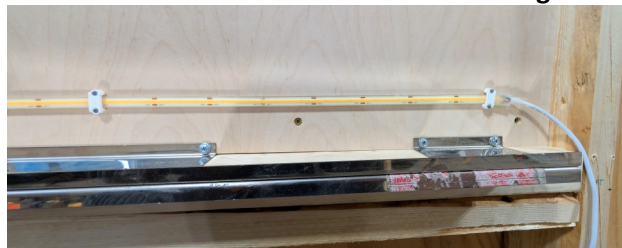

Figure #5



Figure #6



# Installation



**Caution! Use gloves when handling track**

## Phase 4: Himalayan Salt Bricks

### 1. Salt Bricks:

- Begin by placing two bricks onto the installed track, as shown in Figure #8. Note that each brick has notches that are off-center. Position the bricks so that the shorter notched section faces the wall and , the longer section faces outward.



- Take the next section of salt track and carefully set it into the notches on the top of the placed salt bricks, as shown in Figure #9. Secure the track directly above the blocks just installed, inserting the screws through the pre-drilled holes on the channel. The rest of the track will get screwed down later.
- Continue sliding additional salt bricks into the row, (see figure #10).
- Once all salt bricks are positioned in the row, finish securing the track by installing the remaining screws.
- For the final, top row, install an End Cap Channel instead of a mounting a Mounting Channel. Secure using 3/4" lath screws.
- Repeat the above steps for each additional row of salt and track.

### 2. Cutting Salt Bricks (optional):

- The salt bricks can be arranged in various patterns, such as a staggered brick pattern. To achieve certain patterns, it may be necessary to cut some of the bricks (see figure #11).
- A wet tile saw is recommended for cutting salt bricks. It produces the cleanest cuts and minimizes dust.

**Note:** Alternatively a table saw or miter saw can be used. Due to the corrosive nature of salt, it is crucial to thoroughly clean the saw and remove all salt dust to prevent damage to saw.



*See Page #11 for Customizing Length of Himalayan Salt Feature*

*Images Shown Below for Reference*

Figure #8



Figure #9



Figure #10



Brick Pattern

Figure #11



Cut Bricks



# Installation



## Important

Images below are shown as a reference. It is important to verify heater manufacturers installation steps for connecting lighting.

## Phase 5: Lighting Connections Control System

### 1. LED Light Connections:

- After completing Phase 1 thru 4, begin connecting the LED lights to the light cables run in Phase 2.
- At each light take 1 light cable and connect to the pigtail from the LED light. Repeat for each LED light.

### 2. Power Supply Connection

- Power Supply should be installed in a dry accessible location. Power Supply should not be installed in sauna room.
- Determine how power supply will receive power. This can be from a standard switched 120VAC receptacle or wired into your Sauna equipment power module.
- If wiring into Sauna equipment power module see images below.

**Note:** For your exact setup for salt feature size see Page 11. If you encounter any issues with operation see troubleshooting on Page #12.

### Harvia

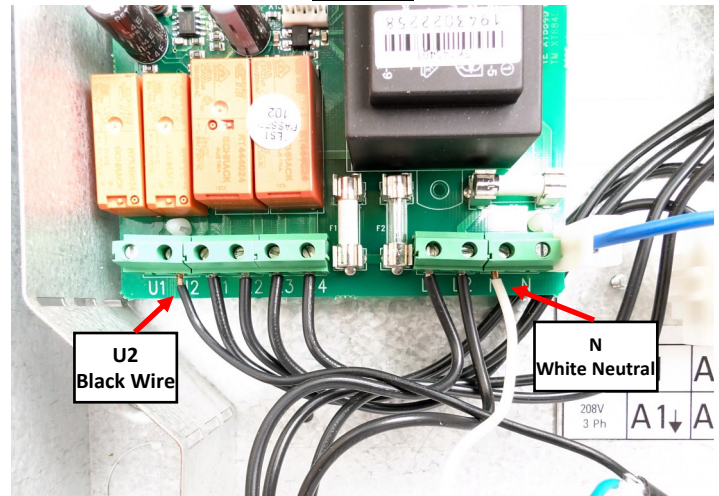

### Saunum

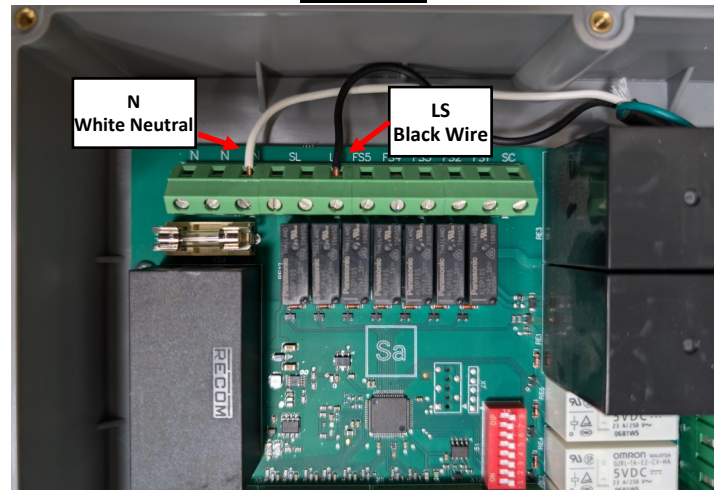

### Huuma

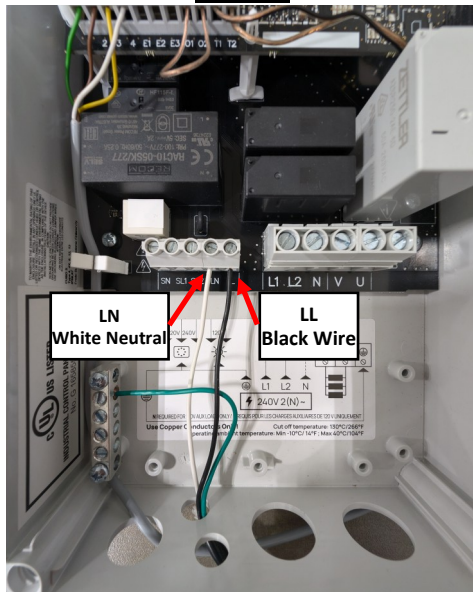

Cut and Remove plug end to wire directly to sauna power module.

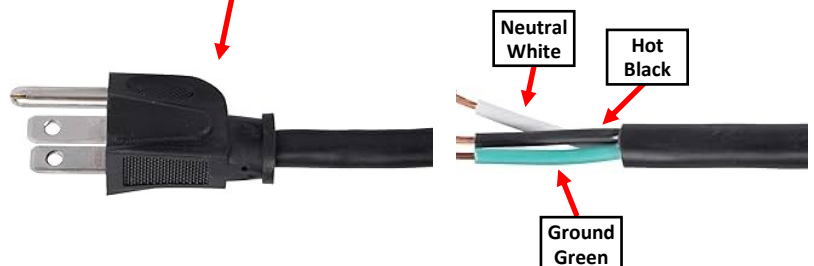

# Installation



*Images Shown Below for Reference*

## Phase 6: Wall Cladding / Furring Boards

### 1. Vapor Barrier

- After building the salt feature, apply a vapor barrier to entire wall surface. Ensure the vapor barrier extends to the edges of the salt feature on all sides.

**Note:** If any additional blocking is required for benching or other fixtures, install this before applying the vapor barrier.

### 2. Furring Boards

- Determine the desired orientation of the tongue and groove (T&G) wall boards. Create a minimum 1.5" standoff from the stud wall using furring strips. In this example the wall boards will be installed vertically (see figure #13).
- Install furring strips, ideally 2x4 boards, spaced approximately every 24".
- A furring strip must be installed at the top and bottom edges of the salt feature.

### 3. Wall Boards / T&G

Wall board thickness can be between 9/16" to 1-3/16".

- Once the furring strips are installed, gather the wall boards.
- Begin installing wall boards from either the left or right side.

**Note:** Ensure the first wall board is perfectly plumb with the salt feature and periodically re-check plumb every few boards as you approach the salt feature.

- Depending on the specific wall boards used, it may be necessary to cut them to fit around the salt feature.

Figure #13



# Installation



**Only width can be modified. Salt Bricks, Track, and LED will need to be cut.**

## Custom Width

To modify the width of your Salt Feature follow the steps below for cutting the Salt Bricks, Track, and LED Strips.

### 1. LED Strip (Phase 3)

- LED strips can only be cut every 1.9" refer to Figure #14 for guidance.
- First determine the desired width for your salt feature.
- Then, divide the feature's desired width by 1.97" to calculate the number of cut points.

**Example:** For a 36" feature, divide 36" by 1.97", which equals 18.27". This gives you 18 cut points, resulting in a width of 35.46"

**Note:** The cut LED strip will be shorter than your desired salt feature width by no more than 2".

- After cutting the LED strip, apply silicone and install the new cap on the cut end.

### 2. Mounting Channel/End Caps (Phase 3)

**Warning: Sharp Edges. Wear Safety Glasses When Cutting.**

- For cutting the mounting channel and end cap, we recommend using either a circular saw or an angle grinder equipped with a blade specifically rated for cutting metal.
- Mark the channel at your desired width. This should be the total width of the salt feature and can be up to 1/2" shorter.

### 3. Salt Bricks (Phase 4)

- We recommend using a wet tile saw to cut the salt bricks.

**Note:** Alternatively a table saw or miter saw can be used. Due to the corrosive nature of salt, it is crucial to thoroughly clean the saw and remove all salt dust to prevent damage to saw.

- Secure the salt brick(s) and make a clean, straight cut at your determined width.

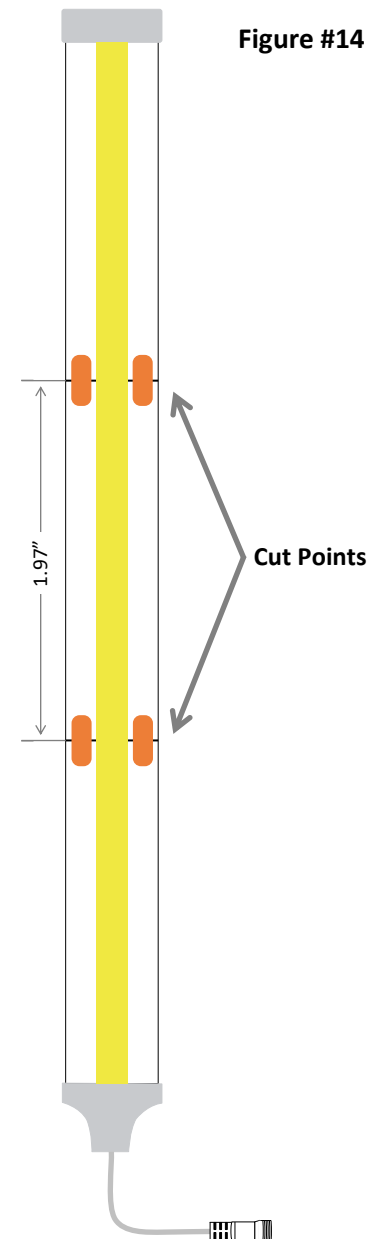

Figure #14

# Connection Diagrams

## Replacement Parts



*Refer to your order for your Salt Feature Size*

### 4" x 48" Universal Salt Feature

	1	2	3	4	5	6	7	8
Description	Salt Brick (not pictured)	4' End Cap Channel	4' White LED Strip	90W Power Supply	AC Power Cable (for power supply)	30' Light Cable	LED Mounting Clip (not pictured)	LED Cap (not pictured)
Quantity	6 (+1 extra)	2	1	1	1	1	4	1
Part Number	127839	129142	BP031178	BP031137	BP031132	BP031077	BP031188	BP031185

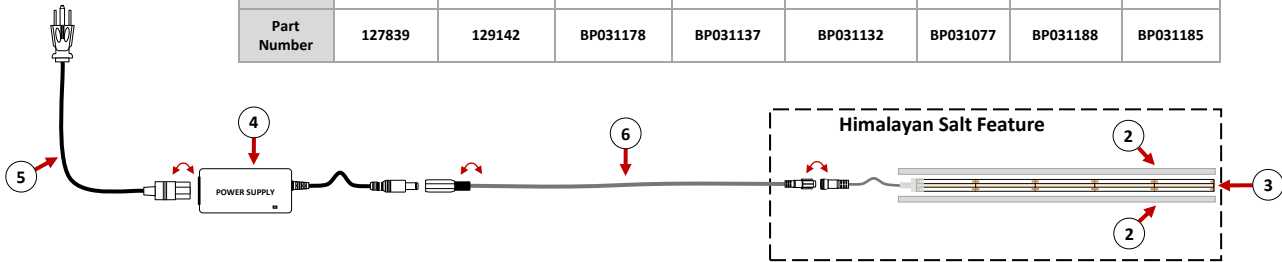

### 12" x 48" Universal Salt Feature

	1	2	3	4	5	6	7	8	9	8
Description	Salt Brick (not pictured)	4' Mounting Channel	4' End Cap Channel	4' White LED Strip	90W Power Supply	AC Power Cable (for power supply)	30' Light Cable	4-Way DC Barrel Splitter	LED Mounting Clip (not pictured)	LED Cap (not pictured)
Quantity	20 (+2 extra)	2	2	3	1	1	3	1	12	3
Part Number	127839	128035	129142	BP031178	BP031137	BP031132	BP031077	BP031138	BP031188	BP031185

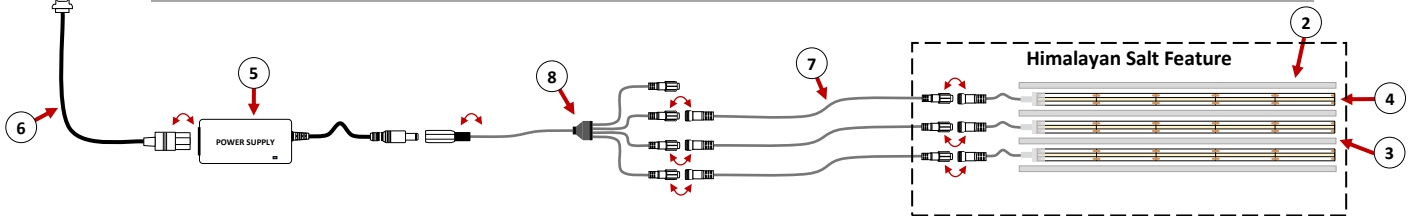

### 12" x 48" Universal Salt Feature

	1	2	3	4	5	6	7	8	9	8
Description	Salt Brick (not pictured)	4' Mounting Channel	4' End Cap Channel	4' White LED Strip	90W Power Supply	AC Power Cable (for power supply)	30' Light Cable	4-Way DC Barrel Splitter	LED Mounting Clip (not pictured)	LED Cap (not pictured)
Quantity	27 (+3 extra)	5	2	4	1	1	4	1	16	4
Part Number	127839	128035	129142	BP031178	BP031137	BP031132	BP031077	BP031138	BP031188	BP031185

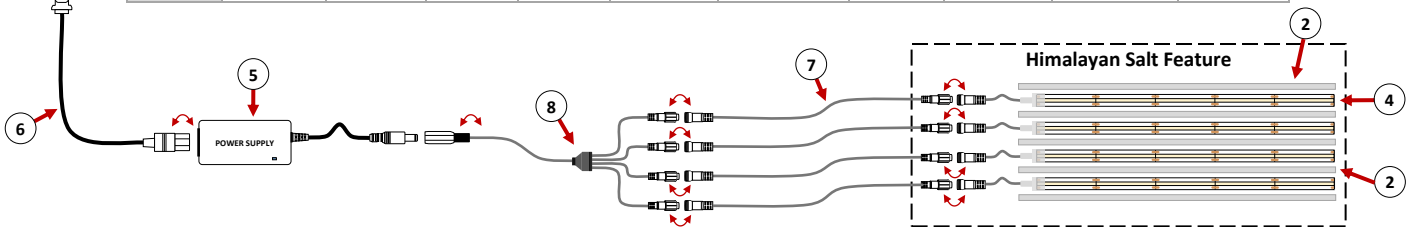

**Himalayan Salt Universal Sauna Light Kit**  
**4" x 48"**



**Weight:** 34lbs +/-

**Framed Opening Dimensions**

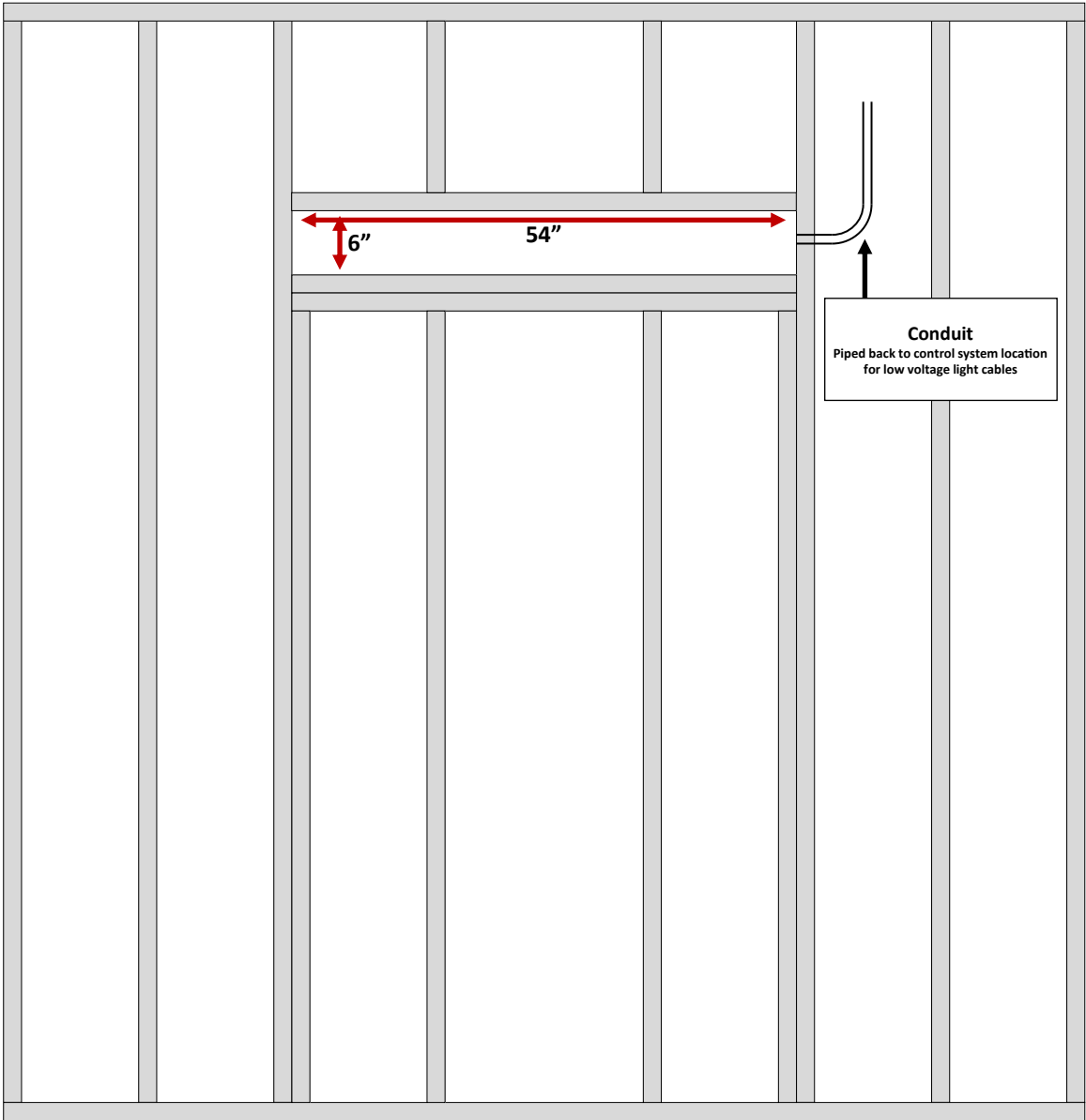

**Front View**

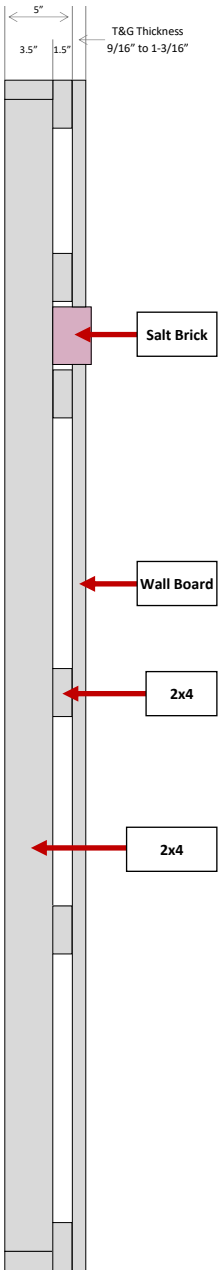

**Side View**

Follow all local building codes for framing.  
Above diagram is for reference only

SKU: BDL-129111  
REV: 1.0\_03/2025



**Himalayan Salt Universal Sauna Light Kit**  
**12" x 48"**



**Weight:** 97lbs +/-

**Framed Opening Dimensions**

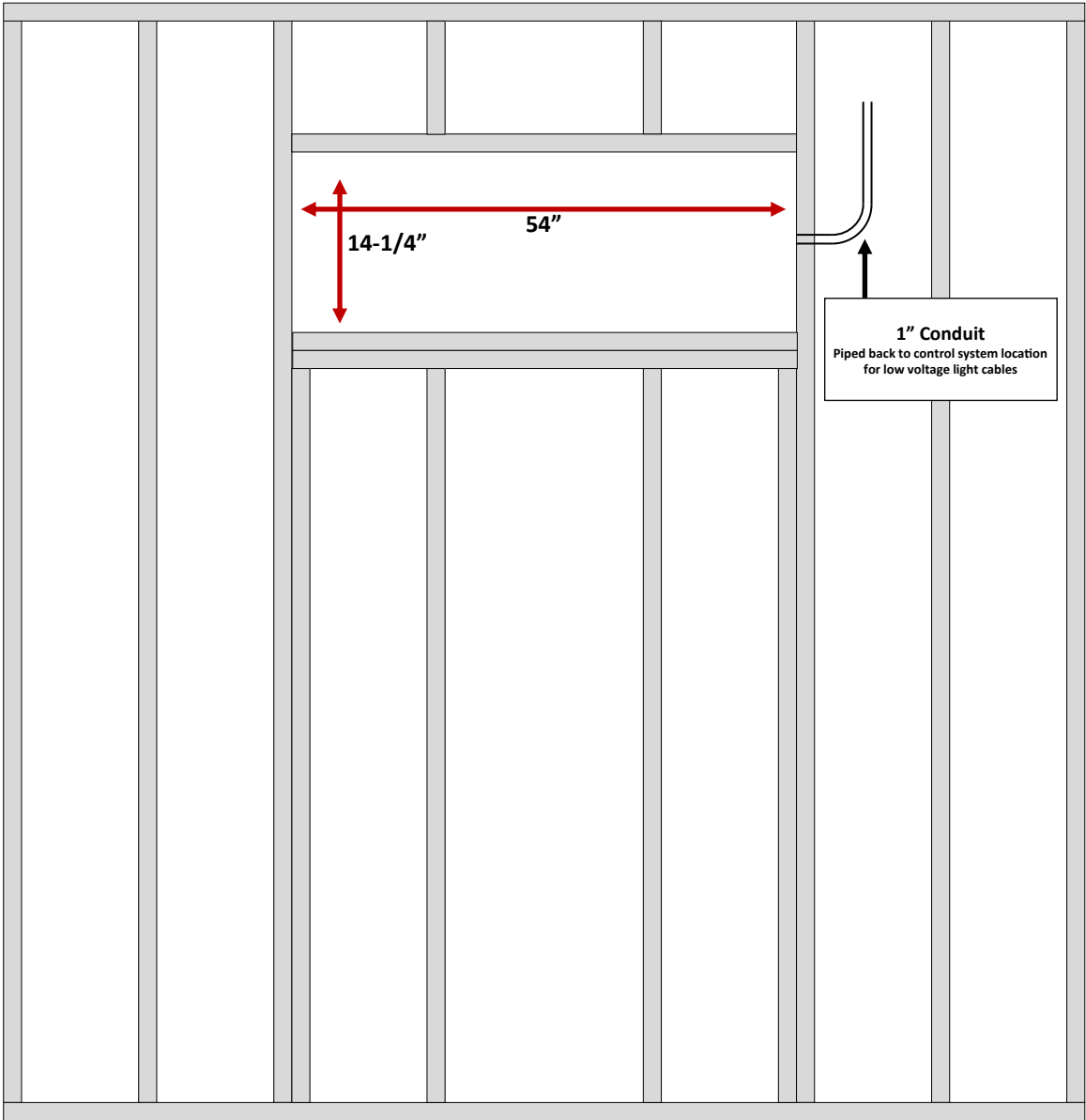

**Front View**

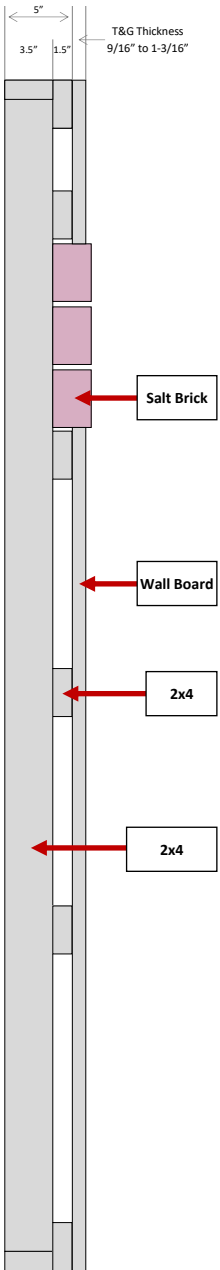

**Side View**

Follow all local building codes for framing.  
Above diagram is for reference only

SKU: BDL-129112  
REV: 1.0\_03/2025

Himalayan Salt Universal Sauna Light Kit  
16" x 48"



Weight: 128lbs +/-

Framed Opening Dimensions

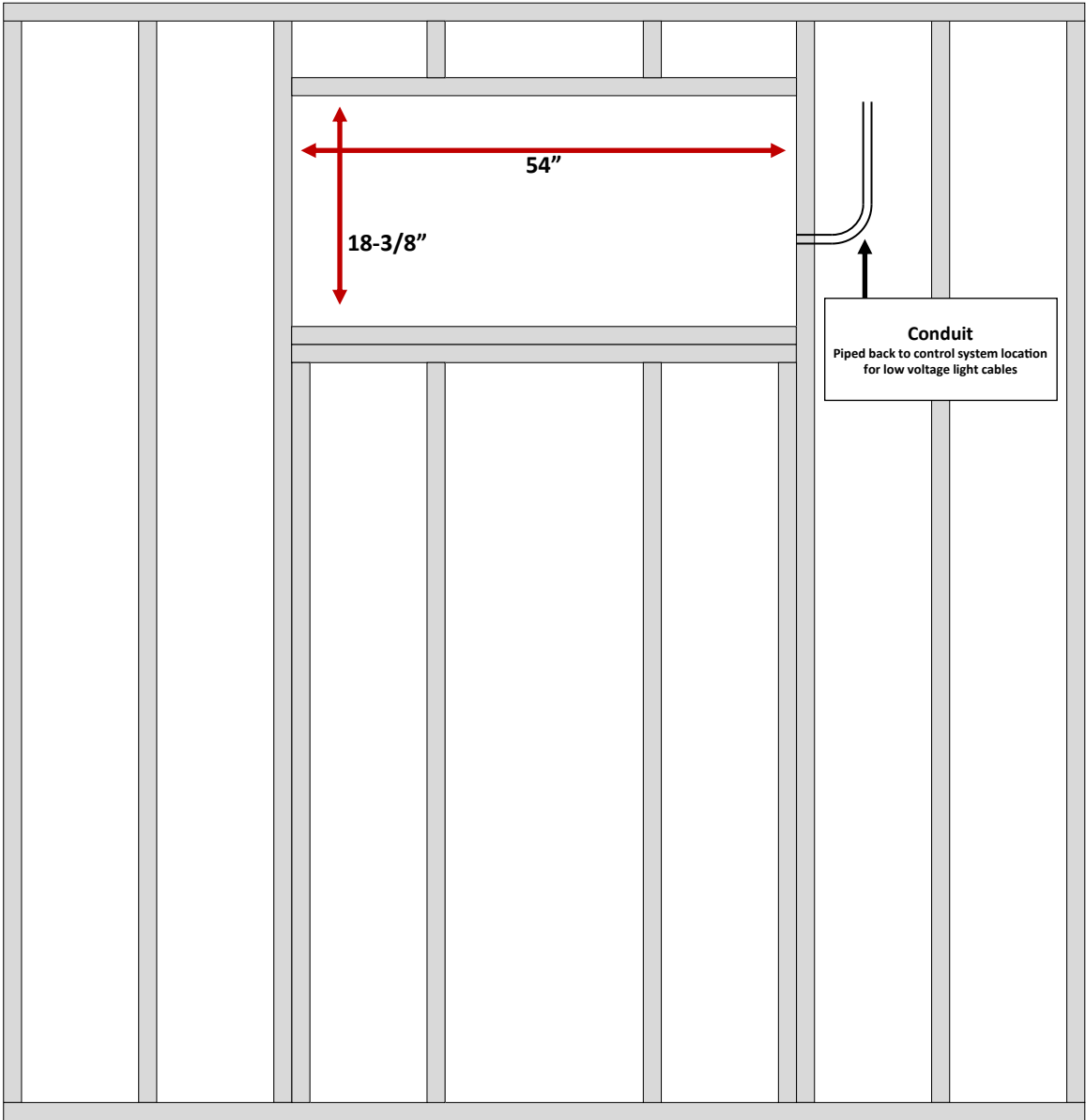

Front View

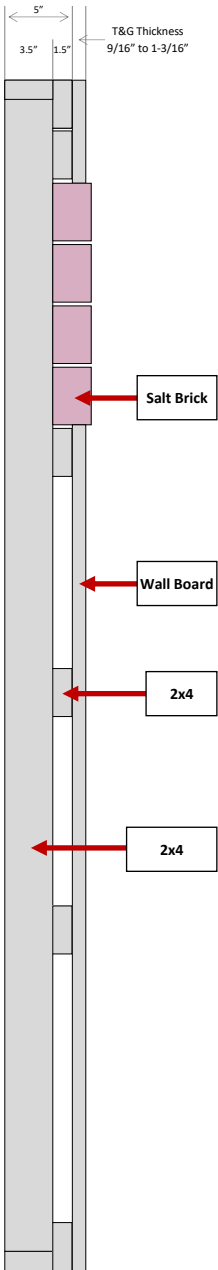

Side View

Follow all local building codes for framing.  
Above diagram is for reference only

SKU: BDL-129113  
REV: 1.0\_03/2025

## Troubleshooting

### No Power

- **Verify Outlet Voltage:** If the power supply is connected to a standard 120VAC outlet, use a voltage tester to confirm that the outlet is providing the correct voltage (approximately 120VAC).
- **Check Circuit Breaker:** If there is no voltage at the outlet, inspect the circuit breaker in the electrical panel to ensure it has not tripped. Reset the breaker if necessary.
- **Verify Sauna Light Circuit Wiring:** If the sauna features lighting system is wired through the sauna manufacturer's light circuit, carefully check that the wiring connections are correct and match the sauna manufacturer's specifications.
- **Enable Light Circuit in Sauna Controls:** Ensure the light circuit is enabled through the sauna manufacturer's control settings.
- **Consult Sauna Manufacturer's Operating Instructions:** Refer to the sauna manufacturer's operating instructions for details on operating the light circuit.
- **Inspect Power Connections:** Carefully verify that all power connections are secure and correctly connected:
  - **Power supply connection:** Check the connection between the power supply and the 120V power source.
  - **DC connections:** Check the connection between the DC plug from the power supply and DC splitter.

### Power Present, Lights Not Illuminating

- **Check Light Cable Connections:** Double-Check that all light cables are securely plugged into both the LED strips and power cables or splitter.
- **Test Individual LED Strips:** To isolate the problem, test each LED strip individually by connecting it directly to the power supply.
  - **Note:** To test an individual LED light, disconnect the 4-way DC splitter and connect the 30ft cable directly to the pigtail lead on the power supply.

***This Page Intentionally Left Blank***



Technical Support  
(224) 253-5909

© 2025 Bathing Brands, Inc.

REV: 1.1\_06/2025